

REMKO RKL

RKL 490 DC

Mobile Inverter Air Conditioning Unit in Split Design

Operation · Technology · Spare parts



Contents

<i>Safety notes</i>	4
<i>Environmental protection and recycling</i>	4
<i>Warranty</i>	4
<i>Intended use</i>	4
<i>Transport and packaging</i>	5
<i>Equipment description</i>	5
<i>Operation</i>	6-7
<i>Installation instructions</i>	7-8
<i>Connector pipes</i>	9-10
<i>Shut-down</i>	11
<i>Troubleshooting and customer service</i>	11
<i>Care and maintenance</i>	12
<i>Electrical connection diagram</i>	13
<i>Exploded view and parts lists</i>	14-17
<i>Technical data</i>	18
<i>Declaration of conformity</i>	19





Read these operating instructions carefully before commissioning / using the device!

These instructions are an integral part of the system and must always be kept near or on the device.

This operating manual is a translation of the German original, Version W-04

Subject to modifications; no liability accepted for errors or misprints!

Safety notes

Carefully read the operating instructions before commissioning the equipment for service. It provides useful tips and information  as well as hazard warnings to prevent injury or material damage . Failure to follow the directions in this manual can result in endangerment to persons, the environment and the equipment itself and will void any claims for liability.

- Keep this manual and the refrigerant data sheet near the unit.
- The unit should be set up and installed only by qualified personnel.
- The set-up, connection, and operation of the unit and its components must be in accordance with the operating conditions stipulated in this manual and comply with all applicable local regulations.
- Mobile units must be set up securely on suitable surfaces and in an upright position. Stationary units must be permanently installed for operation.
- Modification of equipment and components supplied by REMKO is not permitted and can cause malfunctions.
- Equipment and components may not be operated in areas where there is an increased risk of damage. Observe the minimum clearances.
- The electrical supply is to be adapted to the requirements of the equipment.
- The operational safety of equipment and components is only assured if they are fully assembled and used as intended. Safety devices may not be modified or bypassed.

- Do not operate equipment or components with obvious defects or signs of damage.
- All housing parts and openings in the device, e.g. air inlets and outlets, must be free of foreign objects, fluids, or gases.
- The equipment and components must be kept an adequate distance from flammable, explosive, combustible, abrasive and dirty areas or atmospheres.
- Touching some parts of the equipment can result in burns or other injury.
- Installation, repair and maintenance work may be carried out only by authorised specialists. Visual inspections and cleaning can be performed by the operator as long as power is disconnected from the equipment.
- To preclude any danger from the equipment, take appropriate hazard-prevention measures when performing installation, repair or maintenance work or cleaning the equipment.
- The equipment or components are not to be exposed to any mechanical stresses, extreme levels of humidity or direct sunlight.

Disposal of equipment and components

Only recyclable materials are used in the manufacture of the devices and components.

Help protect the environment by ensuring that the devices or components (for example batteries) are not disposed in household waste, but only in accordance with local regulations and in an environmentally safe manner, e.g. using certified firms and recycling specialists or at collection points.



Warranty

Prerequisites for possible warranty claims are customer or his accepting representative has completely filled out the "warranty registration card" supplied with the unit and was completely filled out and returned to REMKO GmbH & Co. KG and placing the unit in service. The warranty conditions are listed in the "General terms and conditions". Furthermore, only the parties to a contract can strike special agreements beyond these conditions. For this reason please contact your contractual partner in the first instance.

Intended use

Depending on the model, the equipment and the additional fittings with which it is equipped is only intended to be used as an air-conditioner for the purpose of cooling or heating the air in an enclosed room.

Different or additional use shall not be classed as intended use. The manufacturer/supplier assumes no liability for damages arising from an unintended use of the equipment. The user bears the sole risk in such cases.

Using the equipment as intended also includes working in accordance with the operating manual and installation instructions and complying with the maintenance requirements.

Environmental protection and recycling

Disposal of packaging

All products are packed for transport in environmentally friendly materials. Make a valuable contribution to reducing waste and sustaining raw materials. Only dispose of packaging at approved collection points.

Transport and Packaging

The equipment is shipped in sturdy transport packaging. Immediately check the equipment on delivery and make note of any damage or missing parts on the delivery note and inform the forwarding agent and your contractual partner. No warranty can be assumed for later claims.

Equipment description

The device is particularly suited for flexible operation, but can also be mounted in a stationary installation.

The mobile air conditioning unit is comprised of an indoor unit for setting up on the floor indoors and an outdoor unit for wall or ground installation outdoors. In "cooling" mode, the output produced by the compressor precisely matches itself to requirements, and thereby regulates the nominal temperature with minimal temperature deviations.

This "inverter-technology" results in energy savings over conventional split systems and also reduces noise emissions to a particularly low level. The flexible connection pipe serves to transport the heat outdoors.

The outdoor unit discharges the absorbed heat to the outdoor air by means of a heat exchanger (condenser). The condensate collected during cooling operation is transported to the outdoor unit by means of a condensate pump integrated into the indoor unit and evaporates via the heat exchanger. The device filters and dehumidifies the air and thereby creates a comfortable room climate.

It works fully automatically and offers numerous additional options thanks to its microprocessor control system. The device can be conveniently operated by means of the infrared remote control unit included.

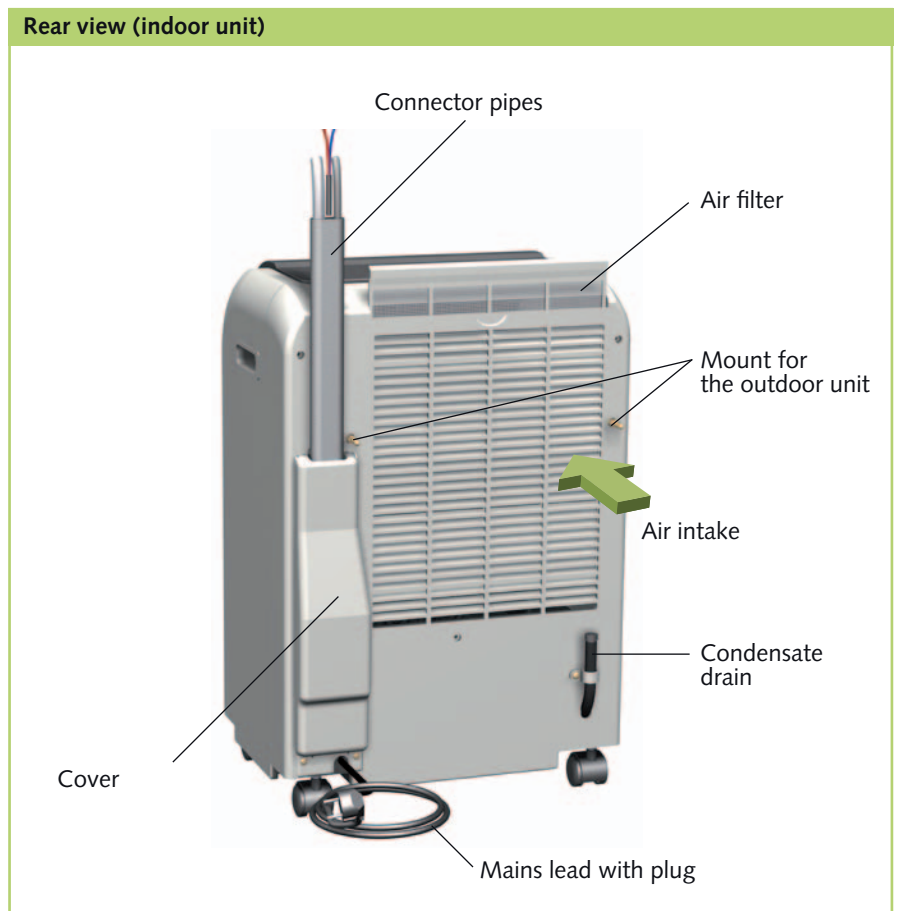
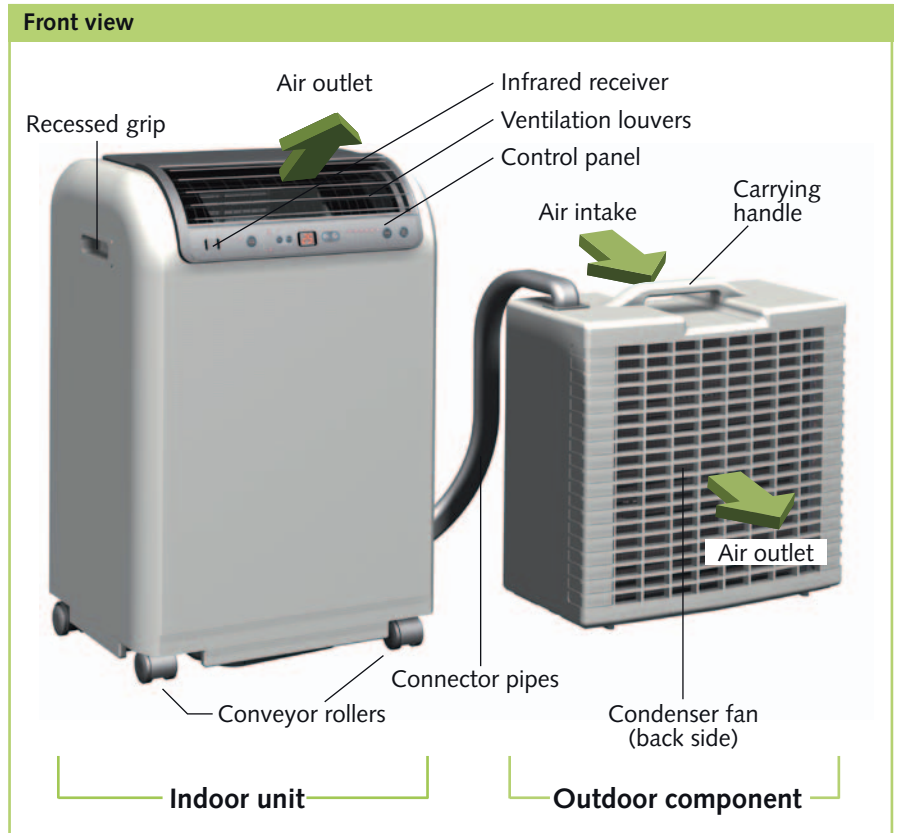

Operation

The system can be operated by means of the control panel on the device or via the standard infrared remote control unit. The functional operation of the buttons among themselves is identical, however, the designation can vary. The batteries must be correctly inserted before the infrared remote control is used.

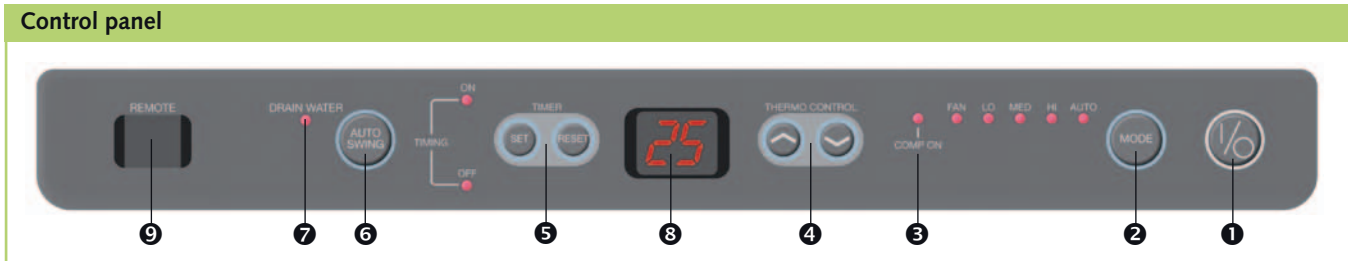

Legend

① "ON / OFF" button

② "MODE" button (Fan speed – mode)

The fan speed is indicated by means of LEDs in the selected modes AUTO→HI→MED→LO or circulated air mode→FAN.

③ LED "COMP. ON" (Compressor operation)

The controller controls the cooling output by means of switching the compressor on or off. Compressor operation is indicated by means of the LED. If the LED flashes, the compressor will be activated in max. 3 mins.

④ Button "▼ ▲" Temperature setting

The desired nominal temperature can be set with the ▼▲ buttons in steps of 1°C between 16 and 30°C.

⑤ On and off timer

The timer function can be used to switch the device on or off automatically in hourly intervals ("▼▲" buttons) by means of pressing the "SET" button. The function can be used to program the switch-on timer when the device is off and the switch-off timer when the device is on, for up to 24 hours. Both timers can be deleted by means of pressing the "RESET" button.

⑥ AUTO SWING button

The direction of the discharged air via the oscillating fins can be adjusted to fixed or oscillating by pressing the "AUTO SWING" button.

⑦ LED "DRAIN WATER"

If the pump is unable to transport the collected condensate then this is signalled via an acoustic alarm in combination with the flashing "DRAIN WATER" LED. The device will be operational again after the container is emptied by means of the condensate drain.

⑧ Display

The display shows the set nominal temperature or the residual time of a programmed timer.

⑨ Infrared receiver

The device receives the signals from the infrared remote control via the sensor.

⑩ FAN button

The ventilator speed can be adjusted by means of pressing the "FAN" button.

Cooling mode

1. Switch the unit on by means of the "I / O" button.
2. Set the temperature selection switch to the desired nominal temperature.
3. Select the desired fan mode to AUTO, HI, MED or LO by means of the "MODE" button.

Circulated air

1. Switch the unit on by means of the "I / O" button.
2. Select FAN mode by means of the "MODE" button.

The outdoor unit can remain in the room in circulated air mode. However, do not hang the outdoor unit onto the indoor unit.

Dehumidifying mode

Position the indoor unit and the outdoor unit in the room that is to be dehumidified.

1. Ensure that the indoor unit cannot extract warm air from the outdoor unit.
2. Do not hang the outdoor unit onto the indoor unit.
3. **Please observe:** The condensate formed during dehumidification may not be pumped to the outdoor unit as otherwise it will be dissipated back into the air in the room or may run out of the outdoor unit.

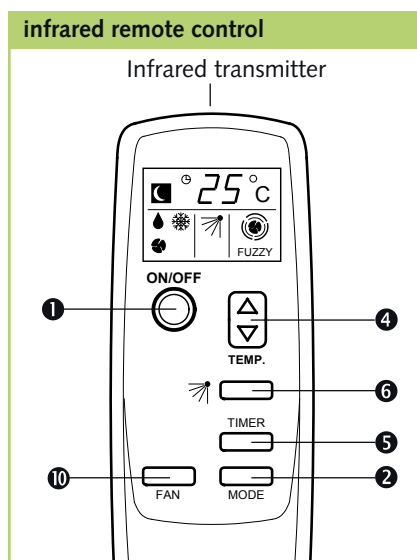

4. Take the condensate drain hose on the back of the indoor unit out of its bracket and remove the plug.
5. Allow the condensate to drain downwards into a drain or container.

CAUTION

Ensure that the external container does not overflow. This could result in water damage.

6. Switch the unit on by means of the "I / O" button.
7. Set the temperature selection switch to the lowest nominal temperature.
8. Set the "MODE" button to the lowest fan speed "LO".

Installation instructions

The device is supplied in a fully operational condition and is equipped as standard with a connection pipe linking the indoor and outdoor devices, meaning that it is ready for use. The scope of delivery includes various accessories for mounting the outdoor unit.

The indoor unit

The indoor unit is positioned at the desired location with the air discharge side pointing into the room. When positioning, ensure there is a minimum gap of 20 cm around the device.

Connector pipes

The connector pipes can be laid through a tilted window or through a gap in the door. The connector pipe can be sepa-

rated from the indoor unit, meaning that there is the additional option of fitting it to a wall opening (\varnothing min. 60 mm).

Please note the following information when laying the connector pipes:

- The connector pipes may not be jammed in or kinked.
- There may not be any tension or other mechanical stress exerted on the connector pipes.
- The pipe insulation and the protective jacket may not be damaged.

Outdoor component

The outdoor unit expels the heat from the room into the outside air. In order to do so, the outdoor unit can be positioned on the ground or mounted on an external wall.

Installation on the ground

It is not necessary to use any mounting accessories when installing the outdoor unit on a patio or balcony.

The outdoor unit should be positioned vertically and protected from direct sunlight. A minimum gap of 20 cm should be maintained from the air discharge side to the wall.

It must be ensured that the air can be discharged freely (min. 50 cm gap to any obstacles). The connecting pipe is fed through a gap in the window or door (Fig. 2 and 3).

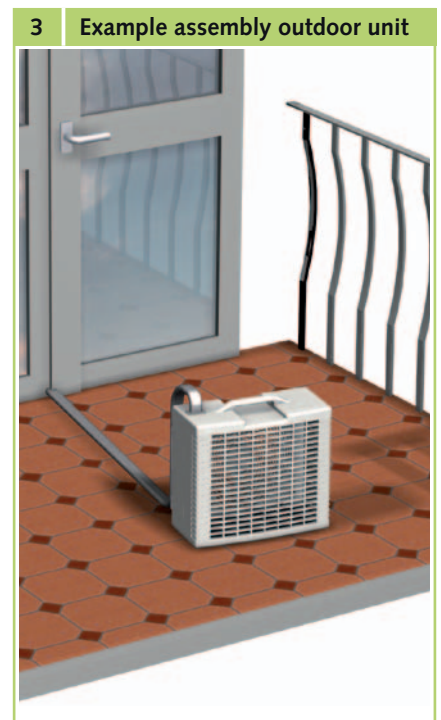
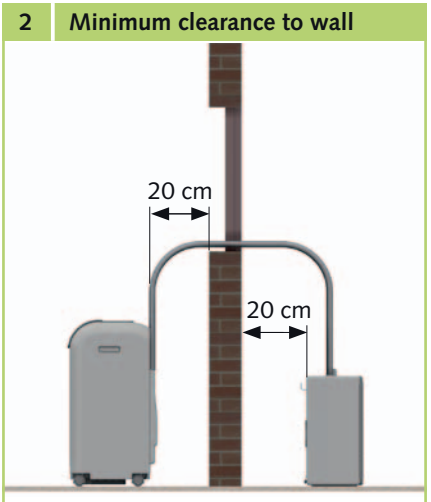

Mounting on an external wall with wall bracket

- Fasten to the wall using the supplied wall bracket.
- Hook the outdoor unit into the wall bracket and secure it with the supplied M4 bolts (Fig 4 and 5).

The wall brackets can be fastened with the supplied fastening elements (dowel 6mm and screws).

Should this not be suitable for the characteristics of the wall then the fastening elements should be selected on site to ensure suitable holding force.

When mounting, ensure that the cable is not stressed and that the insulation is not damaged in the process. Maintain the minimum gaps. The air outlets of the indoor and outdoor units may not be blocked.

Mounting height

The outdoor unit (lower edge) may only be mounted max. 1.8 m above the installation level of the indoor unit (Fig. 6). If the outdoor unit is mounted below the installation level of the indoor unit, then the height difference may not exceed 1.5 m.

External wall mounting with fastening straps

Fastening straps are an additional option for mounting the outdoor unit to an external wall or parapet wall.

- Hook the wall bracket onto the outdoor unit and secure it with the screws (M4).
- Hook one end of the fastening strap with the spring catch into the fastening eyelet of the outdoor unit.
- Hook the other end of the fastening strap into the eyelet bolt which is to be attached to the on-site external wall or parapet wall (Fig. 7). Ensure sufficient stability.

4 Required air circulation

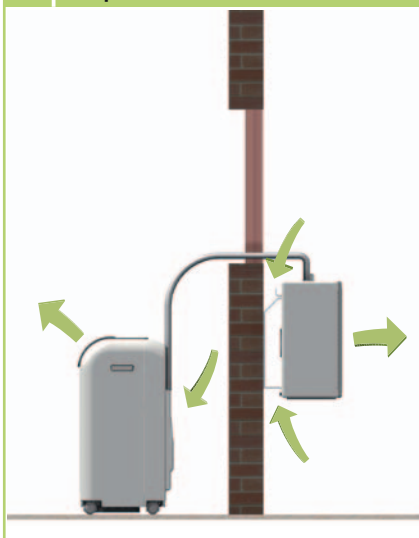

NOTE

Depending on weather conditions it is possible that condensate will run out of the condensate drain on the rear of the outdoor unit. This is a normal process. Select the installation site for the outdoor unit in such a way as the draining water cannot cause any form of damage or hook up the connection to a drain.

5 Gaps assembly bracket

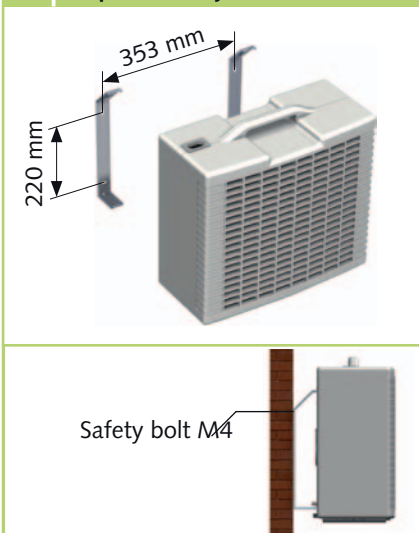

6 Max. assembly height

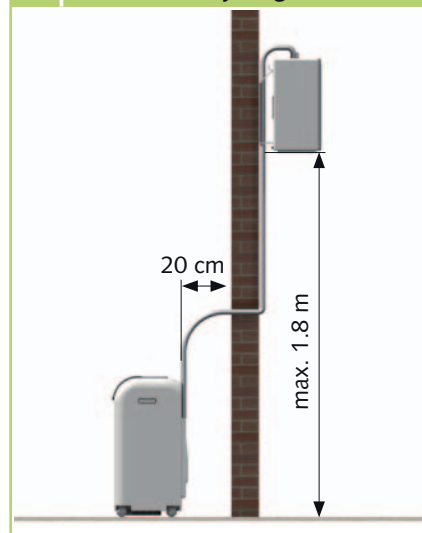

7 Assembly with fastening straps

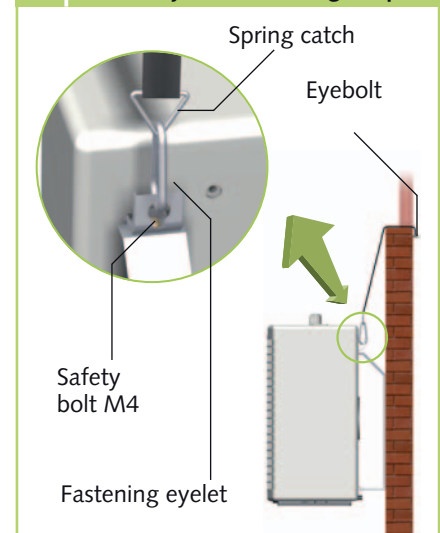

Connector pipes

The connection pipe is connected to the indoor unit with quick-release couplings.

This offers the option of disconnecting the connection pipe for purposes of assembly without the risk of losing refrigerant.

CAUTION

The unit must be disconnected from the mains supply during the entire process! It may only be switched back on when all of the connections have been made and checked. The fastenings and all of the covers must be attached beforehand.

CAUTION

Suitable protective gear must be worn when connecting or disconnecting the connection pipe.

Instructions for disconnecting the connector pipes:

- Disconnect the devices only immediately before assembly and only leave the devices disconnected for as long as is absolutely necessary.
- Before the pipes are reconnected, it is to be ensured that there is no dirt, moisture or other foreign bodies in the quick release couplings which could impair their function.
- Always mount the cable strap as soon as the pipelines are connected.
- The pipelines may only be disconnected and connected by authorised specialist engineers.

- The device can be disconnected and reconnected approx. 7 times without experiencing a noticeable loss of cooling performance, assuming the work is carried out properly.

In doing so, the following procedure must be adhered to:

1. Switch the unit off.
2. Remove the mains plug from the mains socket.
3. Remove the 2 screws from the cover on the rear side of the device (**Fig 8**).
4. Remove the cover from the unit.
5. Unscrew the cable strap from the connection pipe (**Figure 9**).
6. Push in the side clips on the plugged connection and pull the plug out of the socket (**Figure 9**).
7. Remove the upper section from the bracket by means of unscrewing the two screws (**Figure 9**).
8. Unscrew the condensate drain hose (**Fig 9**).
9. Unscrew the left-hand union nut with the SW 24 open-ended spanner provided. In doing so, use the second SW 21 open-ended spanner to hold the lower coupling section still (**Fig. 10, page 10**).

CAUTION

Never twist the the fixed lower section.

NOTE

It is possible that residual fluid can leak out of the the condensate hose.

8 Rear view - indoor unit



9 Dismantling the connection pipe

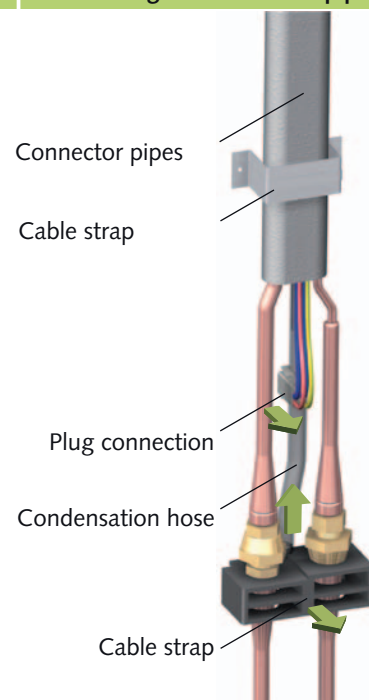

10. Screw continuously until the connection is disconnected.

NOTE

Do not stop screwing in the event that refrigerant escapes and a slight hissing sound is heard.

11. Unscrew the right-hand union nut with the SW 24 open-ended spanner provided. In doing so, use the second SW 21 open-ended spanner to hold the upper coupling section still (**Fig. 11**).

CAUTION

Never twist the the fixed upper section.

12. Screw continuously until the connection is disconnected.

NOTE

Do not stop screwing in the event that refrigerant escapes and a slight hissing sound is heard.

13. Screw the protective caps provided onto the 4 coupling halves (**Fig. 12**).

14. Ensure that there is a wall opening available of \varnothing 60 mm in the event that the connection pipe is to be fed through a wall.

15. After the placement or mounting of the indoor unit and outdoor unit is complete, the connection pipe can be hooked up to the indoor unit in the opposite order.

16. After making the connections, check the quick-release couplings for leaks.

10 Unscrew the left-hand union nut

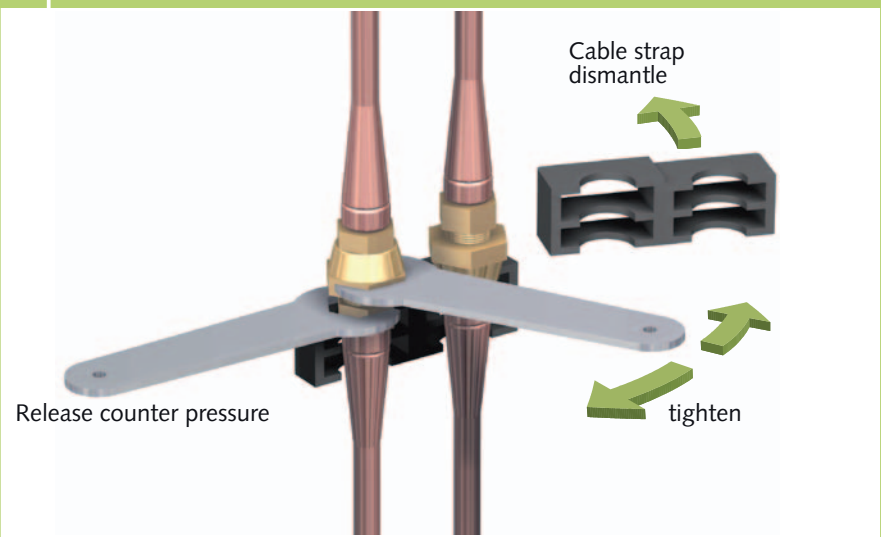

11 Unscrew the right-hand union nut

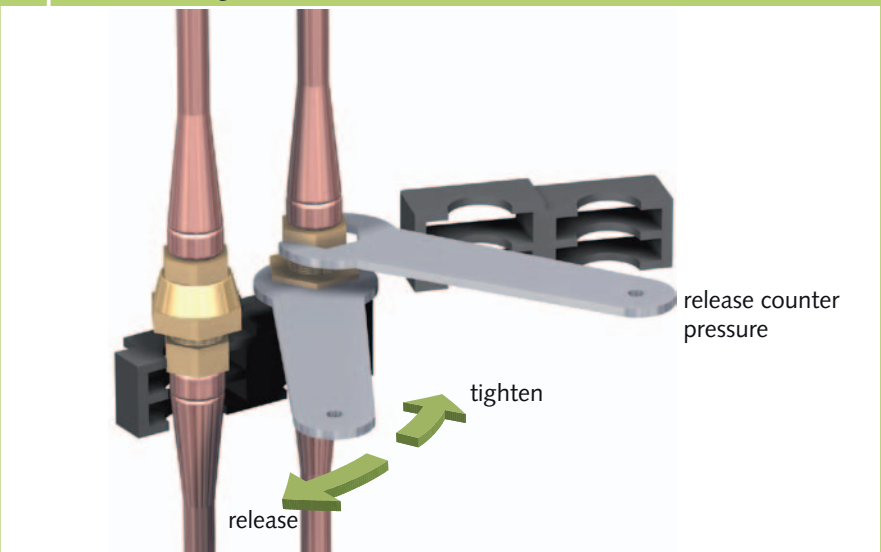

12 Screw on protective caps

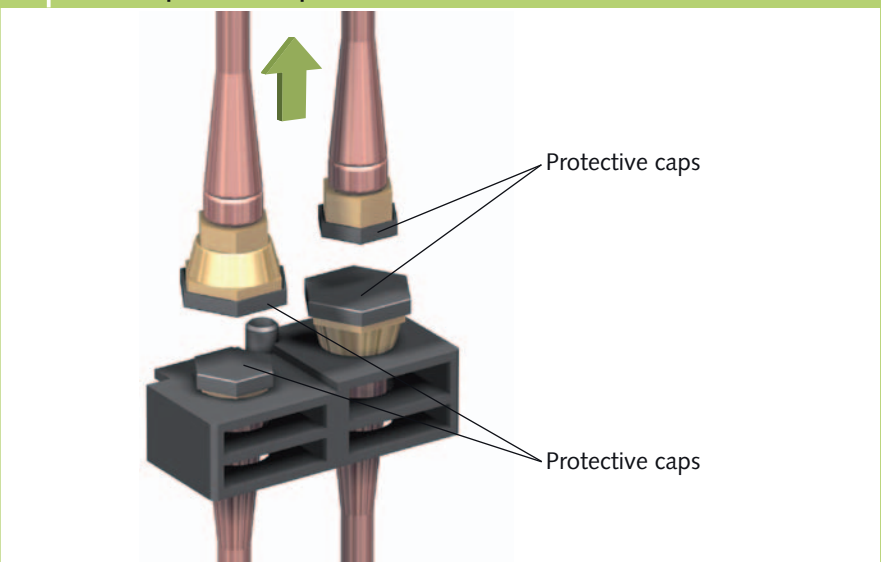

Shut-down



NOTE

Never switch off the equipment by pulling out the mains plug.

Temporary shut-down

If it is planned to shut down the equipment for longer periods e.g. during the winter, proceed as follows:

1. Allow the equipment run for 2-3 hours in circulation mode. This extracts any residual humidity from the unit.
2. Shut down the equipment by pressing the "I / O" button on the operating panel. Only then

should you pull out the mains plug and wind up the cable.

3. Empty the internal condensate container via the condensate drain hose on the rear side of the indoor unit.
4. Make sure that there is no condensate in the outdoor unit before storing the indoor and outdoor unit indoors. To drain the condensate, remove the plug from the outdoor unit.
5. Clean the filter and the plastic surfaces.
6. Hang the outdoor unit onto the indoor unit.

7. Cover the equipment with a synthetic tarpaulin to protect it against dust.
8. Store the equipment in a cool and dry location away from direct sunlight.

Permanent shut-down

The entire system should only be dismantled by a specialist firm familiar with all environmental aspects involved. REMKO GmbH & Co. KG or your sales partner will be pleased to provide details of refrigerant specialists in your area.

Troubleshooting and customer service

The unit has been manufactured using state-of-the-art production methods and tested several times to ensure its correct function. If malfunctions should occur, please check the unit as detailed in the list below. If all functional checks have been carried out and the device still fails to operate properly, then please notify your nearest specialist dealer.

Fault	Possible cause	Remedial measures
The unit does not start	Mains failure	Check voltage and if necessary wait until power is back on
	Mains fuse or controller fuse faulty	Arrange to have exchanged
	Mains plug not inserted in socket	Insert mains plug
	Condensate container full, display "DRAIN WATER" flashes	Empty container via condensate drain hose
	Timer mode active	Wait for timer period to expire or press "I / O" button again
The unit is running with Reduced ventilation output	Used air or outlet openings soiled or blocked by foreign bodies	Clean the openings Remove foreign bodies
	Filter soiled	Clean the filter in accordance with the instructions
	Outdoor unit soiled	Clean the fins on the inside of the outdoor unit
	Cooling load of the room excessive	Reduce the thermal load
Condensate leaks out of the unit	Device standing at an angle	Position vertically, ensure stable positioning
	Plugs missing from condensate drain hose	Seal the hose so that it is watertight again

Care and maintenance

Regular care and observation of some basic points will ensure trouble-free operation and a long service life of the unit.

The device should be checked and thoroughly cleaned after each prolonged use, but in any case at least once per year.

The entire plant is designed as a maintenance free, hermetically sealed system and may only be maintained or repaired by specialist authorised firms.

CAUTION

Prior to performing any work, ensure the equipment is disconnected from the voltage supply and secured to prevent accidental switch-on!

- Clean the equipment using a damp cloth. Do not use a jet of water.
- Do not use any caustic, abrasive or solvent-based cleaning products.
- Only use suitable cleaning agents, even in the event of severe soiling.
- Empty the condensate container and check if the diameter of the condensate lines have tapered as a result of soiling prior to and after each operating season. If this is the case, they must be cleaned.

NOTE

Check the level of dirt on the on the exchanger fins.

- Clean the air filter on the indoor unit at regular intervals, and more frequently if necessary.
- It is recommended that you take out a maintenance contract with an appropriate specialist firm.

TIP

This enables you to ensure the operational reliability of the plant at all times!

1 Remove filter



NOTE

Never operate the indoor unit without the original filter. The heat exchanger fins on the indoor unit with soil up if operated without a filter and the device will suffer performance loss.

Air filter for indoor unit

Clean the air filter at intervals of no more than 2 weeks. Reduce this interval if the air is especially dirty.

Cleaning the filter on the indoor unit

Please proceed as follows in order to clean the unit:

1. Remove the mains plug.
2. Pull the filter out of the unit (Fig 1).
3. Clean the filter of dust. Use a vacuum cleaner in the event of slight soiling.
3. In the event of more severe soiling, carefully clean in luke-warm water.
4. Subsequently allow the filter to dry in the air.
5. Insert the filter back into the device.

Electrical connection diagram

Legend

- PCB 1 = Control board
- PCB 2 = main board
- SM = Swing Motor
- FM 1 = Vaporiser fan
- FM 2 = Condenser fan
- WM = condensate pump
- CM = Compressor
- OLP = Compressor excessive temperature protection
- CX 1 = Condenser, vaporiser fan
- CX 2 = Condenser vaporiser fan
- CX 3 = Condenser compressor
- RT = Sensor circulating air temperature
- CT = sensor frost protection
- MS 1 = Microswitch alarm (container full)
- MS 2 = Microswitch condensate pump

Colour code

- | | |
|------------|-------------|
| Y = yellow | BR = brown |
| W = white | BK = black |
| R = red | GR = Grey |
| BU = blue | OR = orange |

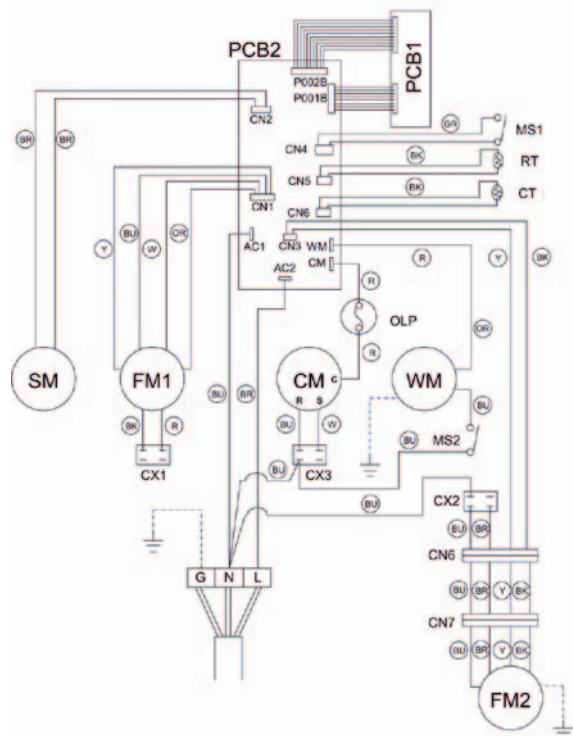

REMKO RKL

Exploded view indoor unit

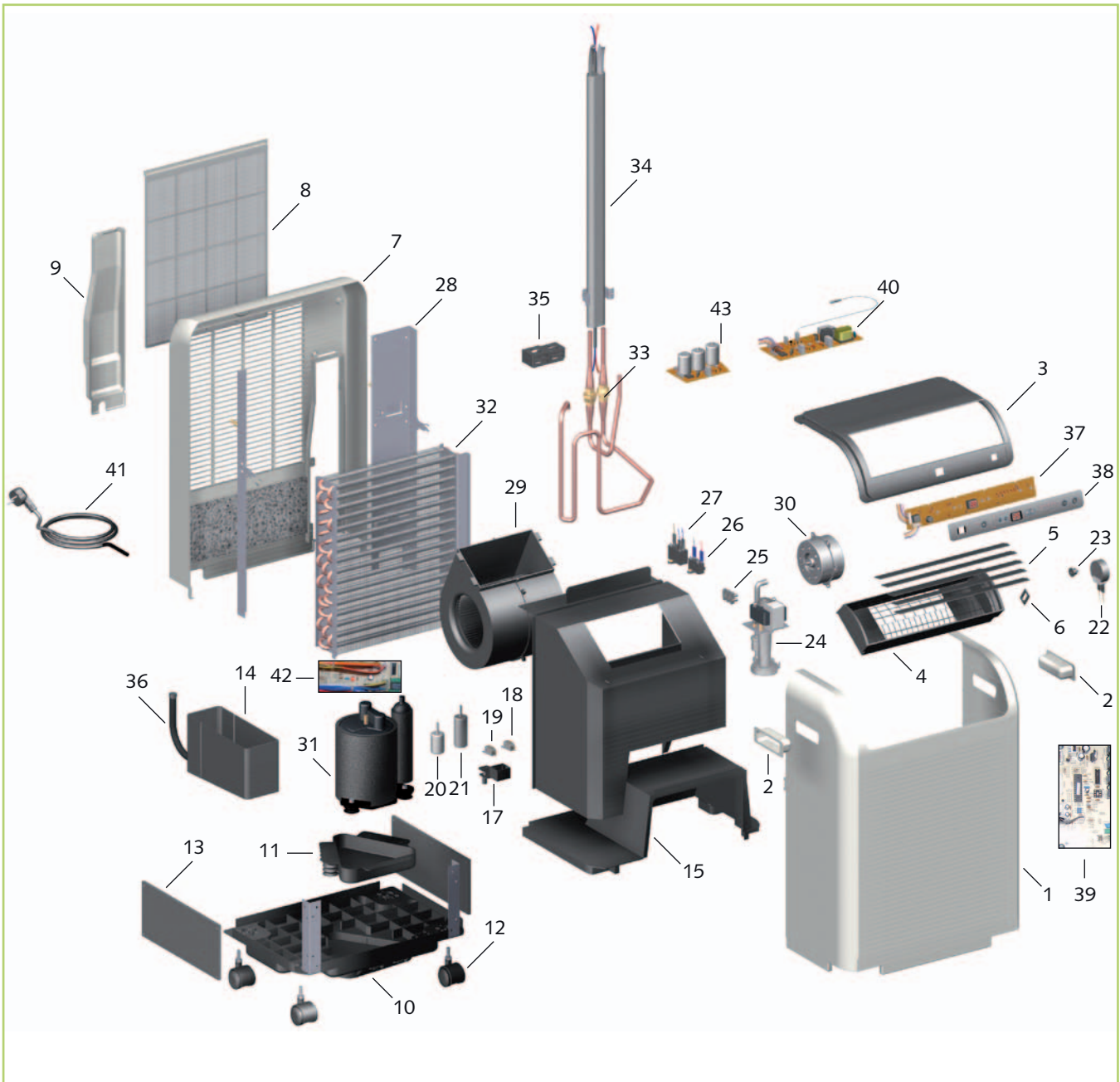

We reserve the right to modify the dimensions and constructional design as part of the ongoing technical development process.

Spare parts list

No.	Designation	RKL 490 DC	RKL 490 DC <i>S-LINE</i>
1	Front panel	1106060	1106120
2	Recessed grip	1106061	1106121
3	Cover, top	1106062	1106062
4	Exhaust grille	1106063	1106063
5	slats	1106064	1106064
6	Shift lever for fins	1106065	1106065
7	Back wall	1106066	1106122
8	Air filter	1106067	1106123
9	Cover for connection pipe	1106068	1106124
10	Device base	1106069	1106069
11	Base plate, cpl.	1106070	1106070
12	Conveyor rollers	1106071	1106071
13	Side cover, right / left	1106072	1106072
14	Condensate container	1106073	1106073
15	Partition wall	1106074	1106074
17	Holder for microswitch	1106076	1106076
18	Microswitch, (container full)	1106077	1106077
19	Microswitch, (pump on / off)	1106078	1106078
20	Float, (container full)	1106079	1106079
21	Float, (pump on / off)	1106080	1106080
22	Swing motor for fins	1106032	1106032
23	Coupling for swing motor	1106081	1106081
24	Condensation pump cpl.	1106082	1106082
25	Electrical terminal strip	1106083	1106083
26	Condenser, vaporiser fan	1106002	1106002
27	Condenser, liquefier fan	1106003	1106003
28	Frame, rear right	1106085	1106085
29	Fan, cpl.	1106099	1106099
30	Vaporiser fan	1106087	1106087
31	Compressor, cpl.	1106148	1106148
32	Vaporiser	1106142	1106142
33	Coupling, set (1x m / 1x w)	1106139	1106139
34	Connection pipe, cpl.	1106140	1106140
35	fastening block, cpl.	1106093	1106093
36	Condensate drain hose	1106094	1106094
37	Keypad board	1106143	1106143
38	Keypad foil	1106144	1106144
39	Control board	1106145	1106145
40	IPM protection board	1106180	1106180
41	Mains cable with plug	1106146	1106146
42	Main board	1106149	1106149
43	Condenser board	1106181	1106181
	Spare parts (not illustrated)		
	Sensor frost protection	1106131	1106131
	Covering for fan	1106075	1106075
	Air circulation sensor	1106098	1106098

When ordering spare parts, please state the computerised part no., unit number and type (see identification plate)!

REMKO RKL

Exploded view outdoor unit

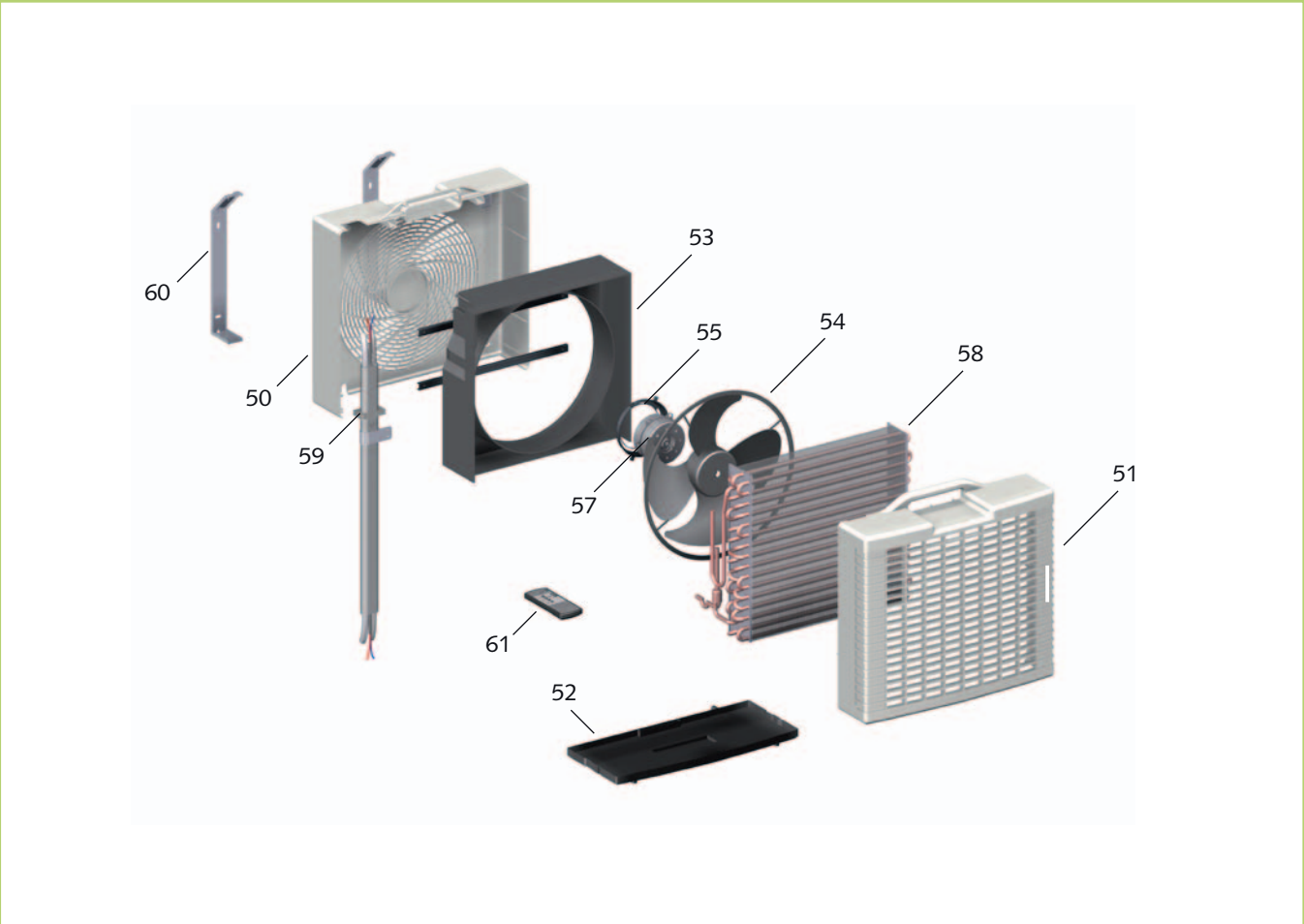

We reserve the right to modify the dimensions and constructional design as part of the ongoing technical development process.

Spare parts list

No.	Designation	RKL 490 DC	RKL 490 DC <i>S-LINE</i>
50	Back wall	1106100	1106125
51	Front panel	1106101	1106126
52	Device base	1106102	1106102
53	Covering for fan	1106103	1106103
54	Condenser fan	1106105	1106105
55	Fastening for vaporiser fan	1106106	1106106
56	Mounting angle	1106107	1106107
57	Vaporiser fan, outdoor unit	1106108	1106108
58	Condenser	1106147	1106147
59	Seal	1106110	1106110
60	Wall bracket	1106111	1106111
61	remote control	1613138	1613138
	Spare parts (not illustrated)		
	Condenser, compressor	1106118	1106118
	Fastening set for outdoor unit, cpl.	1106112	1106112

When ordering spare parts, please state the computerised part no., unit number and type (see identification plate)!

Technical data

Series		RKL 490 DC	RKL 490 DC <i>S-LINE</i>
Operating mode		Mobile Inverter Air Conditioning Unit in Split Design	
Nominal cooling output ¹⁾	kW	3,84 (1,82-4,71)	
Energy efficiency class, cooling ¹⁾		A	
Energy efficiency ratio EER ¹⁾		3,01	
Power consumption, annual, (500h)	kWh	575	
Operating range (room volume), approx.	m ³	120	
Adjustment range indoor unit	°C/%r.F.	+18 to +32 / +35 to +80	+16 to +35 / +35 to +80
Working range outdoor unit	°C/%r.F.	+21-43 / 35 to +80	
Refrigerant		R 410A ³⁾	
Operating pressure max. / per cooling circuit	kPa	4000	
Air volume flow per speed setting, indoor unit	m ³ /h	380 / 520 / 600	480 / 550 / 630
Max. airflow volume outdoor unit	m ³ /h	860 / 1000	
Sound pressure level per speed setting, indoor unit ²⁾	dB(A)	45 / 45 / 52	
Sound pressure level, max. outdoor unit ²⁾	dB(A)	51 / 54	
Power supply	V / Hz	230 / 1~/ 50	
Protection class indoor unit / outdoor unit	IP	24 / X4	
Nom. electrical power consumption, cooling ¹⁾	kW	1,15	
Elec. nominal current consumption cooling ¹⁾	A	5,80	
Elec. starting current, LRA	A	8	
Refrigerant, basic quantity	kg	1,08	
Refrigerant line, max. length	m	3	
Dimensions - interior unit - height/width/depth	mm	695 / 470 / 335	
Dimensions - exterior unit - height/width/depth	mm	490 / 510 / 230	
Weight indoor unit	kg	34,0	
Weight outdoor unit	kg	14,0	
Standard colour		white	silver
Serial number		516...	476...
EDP No.		1613490	1613491

1) Air inlet temperature TK 27°C / FK 19°C, outdoor temperature TK 35 °C, FK 24 °C, max. air flow volume

2) Gap 1 m free space

3) Contains greenhouse gas according to Kyoto protocol

EC – Declaration of Conformity

(in accordance with Machinery Directive appendix II 1A -
Original declaration of conformity)



We do hereby declare that the devices named below, produced and sold by us, satisfy the relevant basic requirements of the EC guidelines, the EC safety standards and other product-specific EC standards.

Name of Manufacturer: **REMKO GmbH & Co. KG**
Air conditioning and heating technology
Im Seelenkamp 12
D - 32791 Lage

Name of CE representative: **REMKO GmbH & Co. KG**
Air conditioning and heating technology
Im Seelenkamp 12
D - 32791 Lage

Equipment (machinery) - Implementation: **Air conditioner combination in split design**

Series / Model: REMKO RKL 490 DC, RKL 490 S-Line
Series / Class Number: 516..... and 476.....

Applicable regulations : MA - RL 2006/42/EC Machinery Directive
(EC-Directive) NS - RL 2006/95/EC Low-Voltage Directive
EMC – RL 2004/108 EEC EMC Directive
EnVKV - RL 92/75/EEC Energy consumption labelling
directive
EC 97/23/EC Pressure Equipment Directive

Applicable Standards: DIN EN ISO 12100-1-2 : 2004-04; DIN EN ISO 13857,
EN 14511 T1-4;
DIN 45635 - 1;
EN 378 – 1-4;
EN 55014 - 1; EN 55014 - 2; EN 55104
EN 60204 - 1; EN 60335 - 1; EN 60335 - 2 - 40;
EN 61000 - 3 - 2; EN 61000 - 3 - 3;

Lage, 25.02.10

REMKO GmbH & Co. KG



.....
Signature Product Manager

REMKO INTERNATIONAL

*... and also right in your neighbourhood!
Make use of our experience and advice*



REMKO GmbH & Co. KG Air conditioning and heating technology

Im Seelenkamp 12
Post-box 1827
Telephone
Fax
Email
Website

D-32791 Lage
D-32777 Lage
+49 5232 606-0
+49 5232 606-260
info@remko.de
www.remko.de

Hotline
Germany
+49 5232 606-0
International
+49 5232 606-130

Consultation

Thanks to intensive training, our consultants are always completely up-to-date in terms of technical knowledge. This has given us the reputation of being more than just an excellent, reliable supplier:

REMKO, a partner helping you find solutions to your problems.

Distribution

REMKO offers not just a well established sales network both nationally and internationally, but also has exceptionally highly-qualified sales specialists. REMKO field staff are more than just sales representatives: above all, they must act as advisers to our customers in air conditioning and heating technology.

Customer Service

Our equipment operates precisely and reliably. However, in the event of a fault, REMKO customer service is quickly at the scene. Our comprehensive network of experienced dealers always guarantees quick and reliable service.

