

REMKO DZ 18 HD

Automatic oil heater

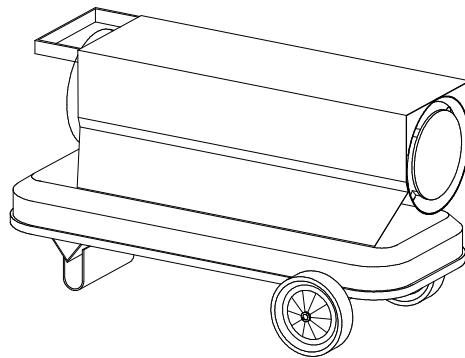

Operation
Technology
Spare Parts

Operating Instructions

Make sure to read these instructions carefully before starting/using the unit!

**Our guarantee will become void when the unit supplied by us is used and installed for inadequate purposes, or maintained incorrectly, etc., or if it is changed without our prior consent.
Subject to alterations!**

Automatic oil heater REMKO DZ 18 HD

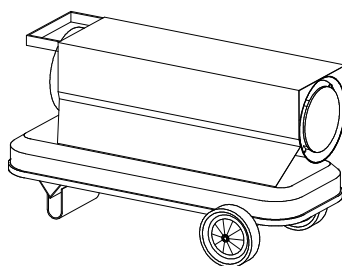

Contents	Page	Contents	Page
Safety Instructions	4	Burner adjustment	9
Description of device	4	Technical data	9
Provision of air heaters	5	Exploded view	10
Installation instructions	6	Spare part list	11
Starting	6	Wiring diagram	12
Unit shut down	7	Service and guarantee	12
Fuel pump	7	Troubleshooting	13
Change the pump to a 2 pipe system	8	Maintenance log	14
Maintenance and service	8		



Always keep these operating instructions near or on the unit!



Safety Instructions

Please make sure that the relevant local building and fire protection codes as well as the regulations of the employer's liability insurance associations are observed when the units are used.

- ◇ The units may be operated only by persons who have been trained in this field.
- ◇ The unit is to be installed and operated in such a way as to ensure that the employees are not endangered by waste gases and radiation heat and that no fire can break out.
- ◇ The unit may only be installed and operated in rooms, when the air-rate fed to the unit is sufficient for combustion.
- ◇ The units may be operated only in well aerated rooms.
- ◇ The permanent stay of persons in the room where the units are installed is prohibited.
Appropriate prohibition signs are to be fitted at the entrances.
- ◇ Mobile fuel reservoirs may be installed only when the technical rules for combustible liquids are observed.
- ◇ The unit is to be installed only on a non-combustible ground.
- ◇ The unit may not be installed and operated in inflammable and explosive surroundings.
- ◇ A safety zone of 1.5 m around the unit, as well as a minimum distance of 3 m from the unit's blower aperture is to be maintained, even in the case of non combustible objects.
- ◇ The blower aperture of the unit may not be narrowed or equipped with hoses and conduits.
- ◇ The protective air suction lattice is always to be kept free from dirt and loose objects.
- ◇ Make sure not to introduce foreign matters into the unit.
- ◇ Make sure not to expose the unit to direct water jets.
- ◇ All electric cables outside the unit are to be protected from damage (e.g. caused by animals, etc.).
- ◇ Make sure always to pull the mains plug out of the mains socket when maintenance and repairs are carried out.

 **During the unit's operation, safety devices may neither be bridged nor blocked!**

 **On account of the construction type, a fixed-location device installation is not permissible!**

Description of Device

The unit is fired directly with heating oil EL or diesel. It is intended for mobile and fully automatic deployment and operated without an exhaust system.

A fuel container is built under the unit and it is equipped with automatic tank heating, a high-pressure atomizing oil burner with optical flame monitoring, a low maintenance axial ventilator, a connection cable with plug, a room thermostat socket and a fivefold filter system.

The unit is in accordance with the basic safety and health requirements of the relevant EU – regulation and is reliable and simple to operate.

The unit can be used e.g. in the following areas:

- for drying new buildings
- for point heating of outdoor workplaces;
- for point heating of workplaces in open, non fire-hazard fabrication rooms and halls;
- for the temporary heating of well aerated rooms;
- for de-icing of machines, vehicles and non flammable storage goods;
- for tempering frost-endangered parts.

Working of Device

The automatic tank heating is activated by connecting the mains plug with a mains socket.

When the unit has been switched on or when heat is required (automatic function with room thermostat) the supply air fan starts. The fan blows air into and along the combustion chamber.

When the preliminary ventilation is over, the solenoid valve opens and supplies fuel to the nozzle. The fuel, sprayed under high pressure, is enriched by an adequate quantity of oxygen according to the heating capacity and ignited by an electric spark.

Ignition is automatically terminated as soon as a perfect flame burns and the flames are monitored by the control IC. After a few seconds hot air is blown out.

The control IC ensures that all the operations of the unit are carried out fully automatically and monitored safely. In case of any troubles, or if the flame is unstable or tends to go out, the unit is switched off by the control IC. The fault indicator warning lamp at the back of the unit lights up.

When the unit has been switched off via the operating switch or the room thermostat, the supply air fan continues running for some time to cool down the combustion chamber and then it stops automatically.

Depending on the required heat rate the function described above is repeated automatically in the case of an operation with thermostat.

 **For optimum unit operation, the device should not be operated at an ambient temperature above 25 °C.**

Provision for Air Heaters

For the deployment of the unit, the relevant guidelines must be observed

1. Operating personnel

- 1.1 The unit must only be operated by persons who have been trained in its operation.

2. Installation

- 2.1 The unit must be installed so that it can stand in a stable position.
- 2.2 The unit must be installed and operated in such a way that the employees are not exposed to the danger of exhaust gases and radiant heat and that the occurrence of fires is ruled out.

- 2.3 The unit may only be installed and operated in rooms if a quantity of air sufficient for the combustion is supplied to the unit and the exhaust gases are removed to the exterior.

A natural air supply sufficient for the combustion is present if e.g.

The room contents in m² correspond with at least 10 times the nominal heat load in kW of all the units operating in the room and if windows and doors ensure a natural change of air.

- 2.4 In deviation from point 2.3, the unit can be operated without an exhaust system in rooms if these rooms have a sufficient air supply and are well ventilated and if materials harmful to health do not reach an unhealthy concentration.

A good natural air supply and ventilation is the case if e. g.

The room contents in m² correspond with at least 30 times the nominal heat output of all units operating in the room and a natural change of air is ensured through windows and doors, or openings which are not lockable are present in the region of ceiling and floor for the air supply and for out going air and the size of these openings in m² corresponds with at least 0.003 times the nominal heat output in kW of all units operating in the room.

- 2.5 The unit must not be installed or operated in rooms and areas where the danger of fire or explosion exists.

3. Room drying

- 3.1 In deviation from point 2.3, in order to dry rooms with an air supply sufficient for the combustion, heating units can be operated without the exhaust gases being removed to the exterior. In these rooms, the permanent presence of persons is forbidden. Signs on the entrances to the rooms must indicate that this is forbidden.

4. Examination

- 4.1 The unit must be tested by an expert as to its work safety specific condition in accordance with the required deployment conditions but at least once annually.
- 4.2 The exhaust values of the burner must be checked.

5. Monitoring

- 5.1 When starting work, the persons commissioned with the operation of the unit must check the unit for obvious defects or deficiencies on the operational and safety mechanisms and check that the safety mechanisms are present.
- 5.2 If defects or deficiencies are discovered, the supervisor must be informed.
- 5.3 In case of defects or deficiencies which endanger the operational safety of the unit, its operation must be terminated.

6. Installation in closed, well aerated rooms without connection to a chimney

- 6.1 The operation of the units is admissible when the minimum air quantity needed for combustion and mentioned in point 2.4 is supplied.
- 6.2 A safe exhaustion of the waste gases is to be ensured to exclude inadmissible pollution.

Fresh air is fed from **below**;

waste gases are exhausted towards the **top**.

7. Correct usage

- 7.1 The units are to be used only for heating purpose in industrial or commercial application because of their construction and equipment.
- 7.2 If specification of the manufacturer or legal regulations, are not followed or if unauthorised changes are made on the unit, the manufacturer is not liable for resulting damages.



The unit is to be installed only in well aerated rooms, but not in living rooms or similar recreation rooms!

Installation Instructions

The units are generally to be operated in accordance with the safety rules, the building code of the land concerned and the fire protection code.

- ◇ Avoid under or overpressure in the room where the unit is installed, as this would result in combustion troubles.
- ◇ Suction and blow-out cross sections may not be reduced
- ◇ It is prohibited to connect conduits or hoses to the unit blow-out opening.
- ◇ Make sure that the technical regulations for combustible liquids are observed when mobile fuel holders are installed.

Outside Installation

- ◇ The units are to be installed outside and to be protected from atmospheric effects to avoid damage.
- ◇ Make sure that no danger or inadmissible annoyance is caused by the operation of the unit.

Room Heating

- ◇ For room heating, hot air generators may only be operated with a room thermostat (accessories).
- ◇ Make sure that sufficient fresh air is fed to ensure perfect combustion. Fresh air is to be fed preferably through windows and doors or through sufficiently dimensioned openings in the outer wall.

Safety Distances

- ◇ Make sure to observe the following safety distances to ensure a safe operation of the unit:
 - towards the top, fire-retarding ceiling 1,5 m
 - towards the sides, non-burning objects 0,6 m
 - blow-off side, with non-burning objects 3,0 m
 - suction side, for perfect air supply 1,0 m
- ◇ The floor and the ceiling must be from fire-retarding materials.

Electric Connection

- ◇ The unit are operated with 230 V alternating current.
- ◇ Electric connection is carried out via a fitted mains cable with shockproof plug.
- ◇ Possibly required extension cables must be selected according to the existing cable length, the unit's connecting line and the intended purpose.

 **All extension cables are to be used only after having been removed from the roller.**

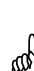
 **The electric connection of the unit is to be carried out via a special supply point with fault current safety switch.**

Starting

Prior to starting, the unit is to be checked to make sure that there are no visible defects on the control and safety devices, that the unit has been installed correctly and that it has been properly connected to the mains.

A properly trained person is to be charged with the operation and control of the unit.

- ◇ Install unit in a stable position.
- ◇ Make sure that combustion air is supplied.
- ◇ Make sure that the air can be sucked in and be exhausted freely.
- ◇ Avoid overpressure and underpressure in the room where the unit has been installed.
- ◇ Make sure that enough fuel is supplied.
- ◇ Fill fuel tank with clean fuel oil EL or diesel with the unit switched off.
- ◇ Use only appropriate and clean tanks to fill with fuel.

 **The unit is to be installed only in well aerated rooms, but not in living rooms or similar recreation rooms!**

Paraffin accumulation by low outside temperatures

The supply of sufficient liquid fuel is to be ensured, even with low outside temperatures.

 **Paraffin accumulation can occur even at temperatures as low as 5 °C. Appropriate measures must be taken to avoid this.**

- ◇ The built-in tank heating is only active as long as the mains plug is connected with a functioning mains socket.
- ◇ It is not possible to get rid of paraffin discharge which is already present using the tank heating.
The requirement for this is the cleaning of the entire fuel system.

Fuel filter

Prior to commissioning the unit and before the tank is filled each time, the main filter (F) must be checked for the presence of grime or the accumulation of paraffin.

The main filter is positioning beside the filler.

Make sure to fill the fuel tank only with the tank filter inserted into the filler neck.

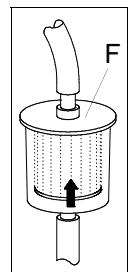

Connect the unit with the current supply

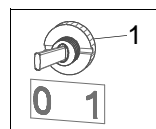

1. Put operating switch **1** into "0" position (OFF).
2. Connect unit plug to a suitable mains socket.
230V/1~ 50 Hz.

Fuel Pump

Heating without room thermostat

The unit runs in continuous operation.

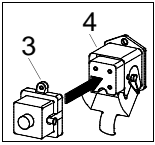

1. Connect the supplied bridge circuit plug **3** to the thermostat socket **4** of the unit

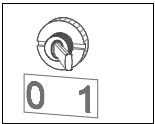

2. Put the operating switch into position "1" (on).

Heating with room thermostat (accessories)

The unit runs fully automatically and depending on temperatures.

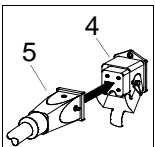

1. Remove the bridge circuit plug **3**.
2. Connect thermostat plug **5** of the room thermostat (accessories) to the thermostat socket **4**.

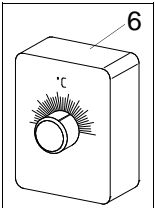

3. Install room thermostat **6** in a suitable place.
The thermostat sensor may not be exposed directly to the hot air current and not fixed directly on a cold surface.



4. Pre-select desired room temperature on the room thermostat
5. Put the operating switch into position "1" (on).

The standard type of the pump runs in a system of 1 pipe. The required fuel is sucked in through the suction line "S".

For the first starting and after having emptied the fuel tank, the fuel system is deaerated through the burner nozzle.

For this purpose the unit is switched on. After a possible switch off through failure, the unit is restarted after having released the automatic burner relay (take care of waiting time).

If, after the 3rd start of the unit there is another switch off through faults, the fuel filters should be checked to make sure that they are free from pollutions and that they are tight.

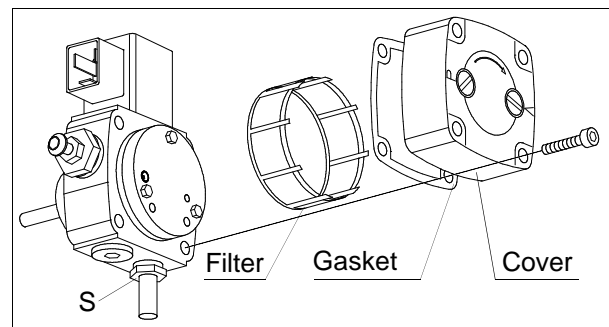

Perfect fuel quality is an absolute necessity for the lubrication of the pump drive.

Suction of water residues should never take place and, in the case of setting, suction should not take place of warping fine dusts (e.g. cement etc.).

Never let the pump run without feeding fuel for a longer period. Make sure not to leave a unit with dry run pump unattended for a longer time.

Unit Shut Down

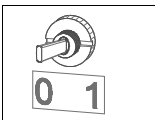

1. Put operating switch into position "0" (OFF).

Attention, important hints to the after-cooling phase

The air supply fan continues running to cool down the combustion chamber and then stops later.

The fan can start several times before final switching off.

Never interrupt (except in emergency situations) the connection to the mains before the end of the whole after-cooling phase.

Our guarantee does not cover damages caused to the unit by overheating.

Setting the pump pressure

The pump pressure can only be set if a manometer is connected to the connection **P**. The pump pressure is changed by turning the pressure setting screw **A**:

- clockwise: increase the pressure.
- counter clockwise: reduce the pressure.

The required pump pressure is determined according to the heating capacity (please refer to unit type plate) and to the nozzle size. The pressure setting screw "A" is to be secured with the counter nut "B" after having set the pressure.

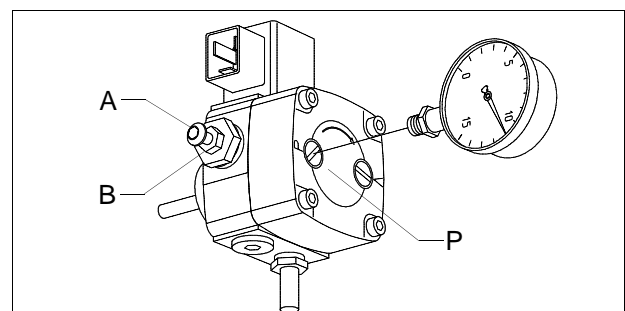

Change the Pump to a 2 Pipe System

If an external fuel tank is used, the pump can be changed to a system with 2 pipes. Fuel is fed to the pump through the suction pipeline. Fuel which is not needed flows back through the return pipe.

Please proceed in the following way to change to the system with 2 trains of pipes:

1. Release fuel conduits and remove fuel pump.
2. Remove the screw **C** and screw the plug **D** out.

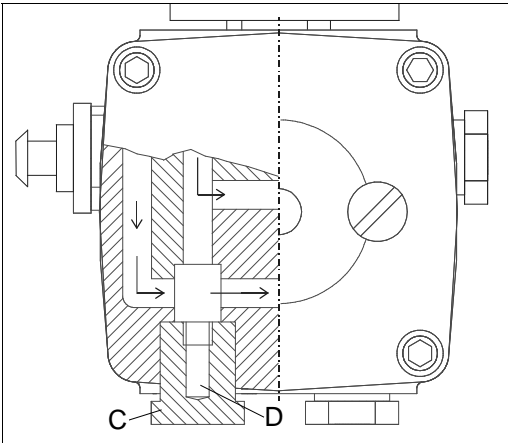

3. Keep the screw **C** for a possible subsequent refitting to a 1 pipe system.

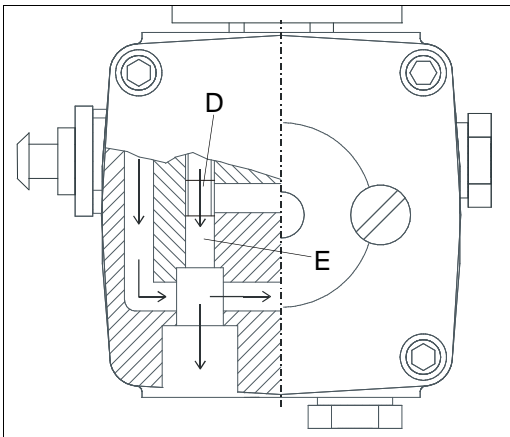

4. Screw the plug **D** for the bypass completely into the opening **E**.
5. Replace the screw **C** by a connection fitting. EDV No. 1102109.
6. Reinstall the fuel pump.
7. Replace the standard main oil filter by a special oil filter for 2 pipes system (accessories).
8. Connect the flow and the return pipe of the fuel pipe and link these with the 2 pipe oil filter.

For the first starting and after emptying the fuel tank the fuel pump is automatically deaerated through the return pipe.

Maintenance and Service

The unit is to be maintained regularly whereby some fundamental rules are to be observed to ensure a long service life and trouble-free operation.

After each heating period or even earlier, depending on the deployment conditions, the entire unit including combustion chamber and burner head must be cleaned of soot sediments, dust and dirt.

The oil filters must also be cleaned / replaced at least once a year or, depending on the degree of contamination of the fuel, frequently.

 **Prior to starting any work make sure to pull the mains plug out of the mains socket!**

 **Setting and maintenance is to be carried out only by authorised personnel!**

- ◇ The unit is to be kept free from dust and other deposits and is to be cleaned only with a dry or humid cloth.
Do not use water jet.
- ◇ Do not use any aggressive cleaning agents or those which are harmful or environmentally unfriendly.
- ◇ When the unit has not been used for a longer period, the fuel tank is to be emptied, rinsed and to be filled with clean fuel.
- ◇ Use only clean fuel oil EL and diesel, respectively.
Make sure to avoid paraffin formation.
- ◇ Empty fuel tank at least twice a year and rinse it with clean fuel.
Do not use water!
- ◇ Keep burner head clean.
- ◇ Wearing parts such as e.g. oil filters, burner nozzle and gaskets must be checked and, if necessary, replaced.
In any case, we recommend the replacement of the oil jet before the start of each heating season.
- ◇ The oil filter in the filler neck of the fuel tank is to be cleaned regularly.
- ◇ The main oil filter is to be replaced (take care of flow direction) depending on the rate of pollution, but at least before the start of every heating period.
The main filter is at the left side of the unit above the fuel tank.
- ◇ Gauze oil filters have been installed in the fuel pump, in the magnetic valve and in the burner nozzle.
These filters are to be cleaned by an expert.
- ◇ Check safety devices regularly.
- ◇ In the case of reducing heating capacity, formation of smoke and/or bad ignition the unit is to be inspected and the burner is to be adjusted.
- ◇ Observe regular maintenance and care intervals.

Cleaning the fuel tank

It is necessary to clean the fuel tank:

- ◇ After each heating period or, depending on the deployment conditions, even earlier.
- ◇ Before and after extended idle periods.
- ◇ If the main filter frequently becomes dirty.
- ◇ If condensation water accumulates in the fuel.

Please proceed in the following way when cleaning the fuel tank.

- ◇ Unscrew the discharging screw **D** (SW 22) and discharge the fuel into a suitable vessel.

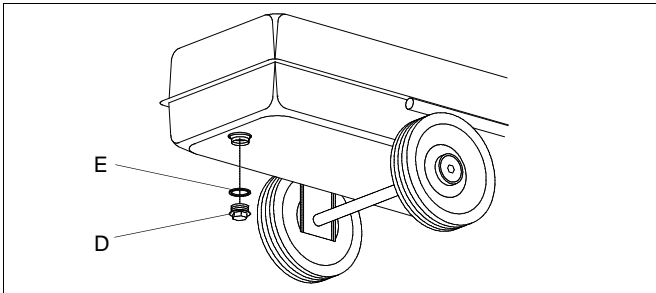

- ◇ Rinse the container several times if necessary with clean fuel thoroughly.
Do not use water!
- ◇ Please use no cleaning agents which contain solvents.
These can destroy the inner layer of the tank.
- ◇ Avoid the use of high-pressure cleaners.
- ◇ Fit the discharging screw **D** (SW 22).
- ◇ The gasket ring **E** should be replaced after each disassembly.
- ◇ Fill tank with clean fuel.
- ◇ Start unit and let it run for approx. 3 minutes.

Burner adjustment

Disassembly of burner head and nozzle

1. Loosen cap nut of fuel piping at burner head.
2. Remove photo cell and ignition cable, and remove the burner head by turning from the rear wall of the burner chamber.
3. When maintenance has been carried out re-assemble all parts carefully in reverse order.
4. Pre-set air flow plate, air slide plate and the ignition electrode distance according to the approximate indications.

 **Use only appropriate tools to disassemble the nozzle (SW 16) and counteract at the blast connection (SW 19).**

Adjustments of the burner head

Fine adjustment of air slide plate by means of CO₂ indicator and soot pump.

CO₂- value: approx. 10 - 12 %

Soot figure: 0 - 1 (by Bacharach)

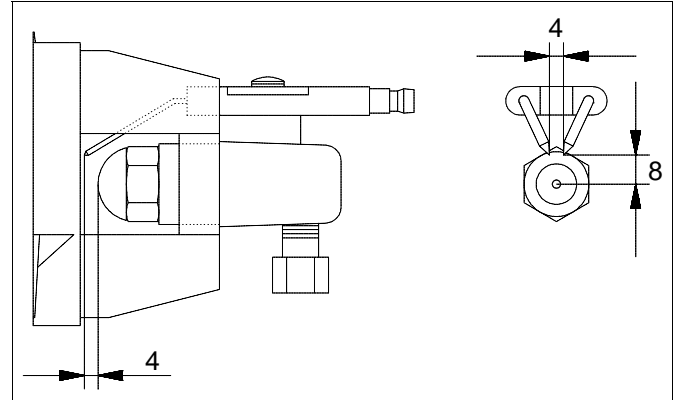

 **Make sure to avoid a flame leakage outside the combustion chamber.**

Technical Data

Nominal heat output	kW	18
Air output	m ³ /h	600
Fuel	fuel oil EL or diesel oil	
Fuel consumption, max.	kg/h	1,52
Nozzle (60°W)	USG	0,4
Pump pressure approx.	bar	11
Tank capacity	Ltr.	16
Electrical connection 1~	V / Hz	230 / 50
Rated current max.	A	1,2
Power consumption max. ¹⁾	kW	0,29
Fuse protection (required)	A	10
Sound pressure level L _{pA} 1m ²⁾	dB(A)	70
Length	mm	810
Width	mm	380
Height	mm	480
Weight	kg	26

1) unit inclusive tank heating

2) noise measuring (when heating) DIN 45635 - 01 - KL 3

Exploded View

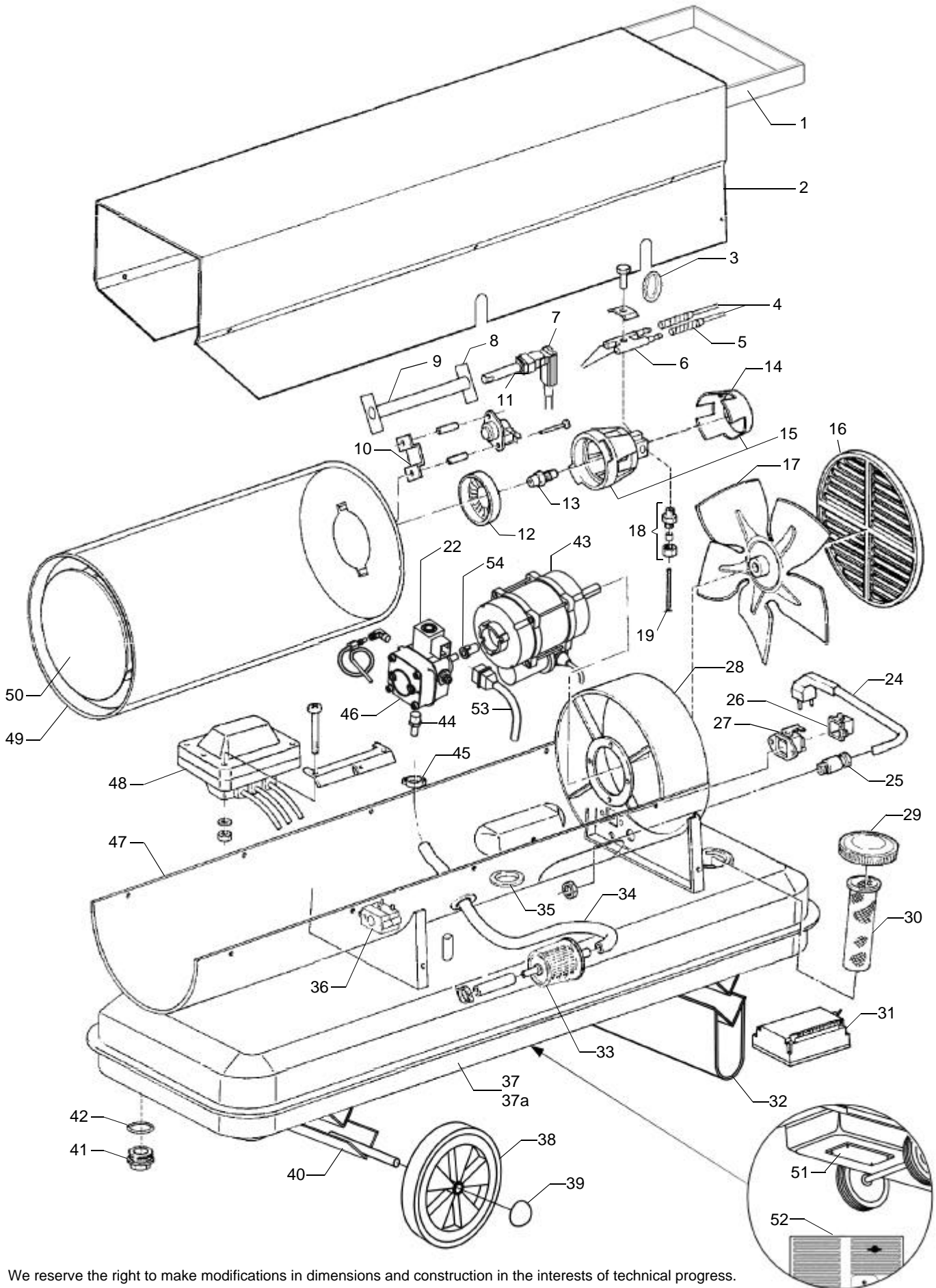

We reserve the right to make modifications in dimensions and construction in the interests of technical progress.

Spare Part List

No.	Description	Ref.-No.
1	transport handle	1108131
2	inspection cover	1101801
3	protective socket, small	1102131
4	ignition cable, kit	1102159
5	protection hose	1101617
6	ignition electrode	1108087
7	photo cell	1108209
8	fastening plate (photo cell holder)	1300980
9	photo cell holder	1102126
10	clamp (thermostat)	1102128
11	recool thermostat	1101027
12	air flow plate	1108448
13	nozzle	1101823
14	air slide plate	1101706
15	burner head, cpl.	1101806
16	protecting grille	1101802
17	fan blade	1102104
18	crimp connection 1/8" x 4 cpl.	1101861
19	copper pipe cpl.	1101860
20	cutting ring with sleeve nut	1102114
21	angle clutch 1/8" x 4	1102112
22	solenoid valve	1103718
23	double nipple	1102110
24	connecting cable with plug	1101320
25	traction relief	1108325
26	bridge circuit plug	1101019
27	thermostat socket	1101018
28	fan housing	1101803
29	filler cap	1101716
30	fuel filter (filler neck)	1101717
31	control IC with toggle switch	1108441
32	support	1108444
33	fuel filter	1102146
34	fuel hose running metres	1102156
35	protective socket, big	1101615
36	auxiliary relay	1102137
37	fuel tank	1101850
38	wheel	1101334
39	wheel cap	1101335
40	axis	1108133
41	drain screw	1102152
42	gasket ring (drain screw)	1102151
43	motor	1101805
44	hose couple 1/4" x 8	1102109
45	clamp (hose)	1102157
46	fuel pump (with solenoid valve)	1103717
47	housing base	1101840
48	ignition transformer	1108096
49	cool jacket	1101830
50	combustion chamber	1101811
51	cover (tank heating)	1102258
52	tank heating cpl.	1102256
53	connection cable (solenoid valve)	1102825
54	pump clutch	1102936

When ordering spare parts please indicate ref.-no. and machine no. (see type plate)!

Wiring Diagram

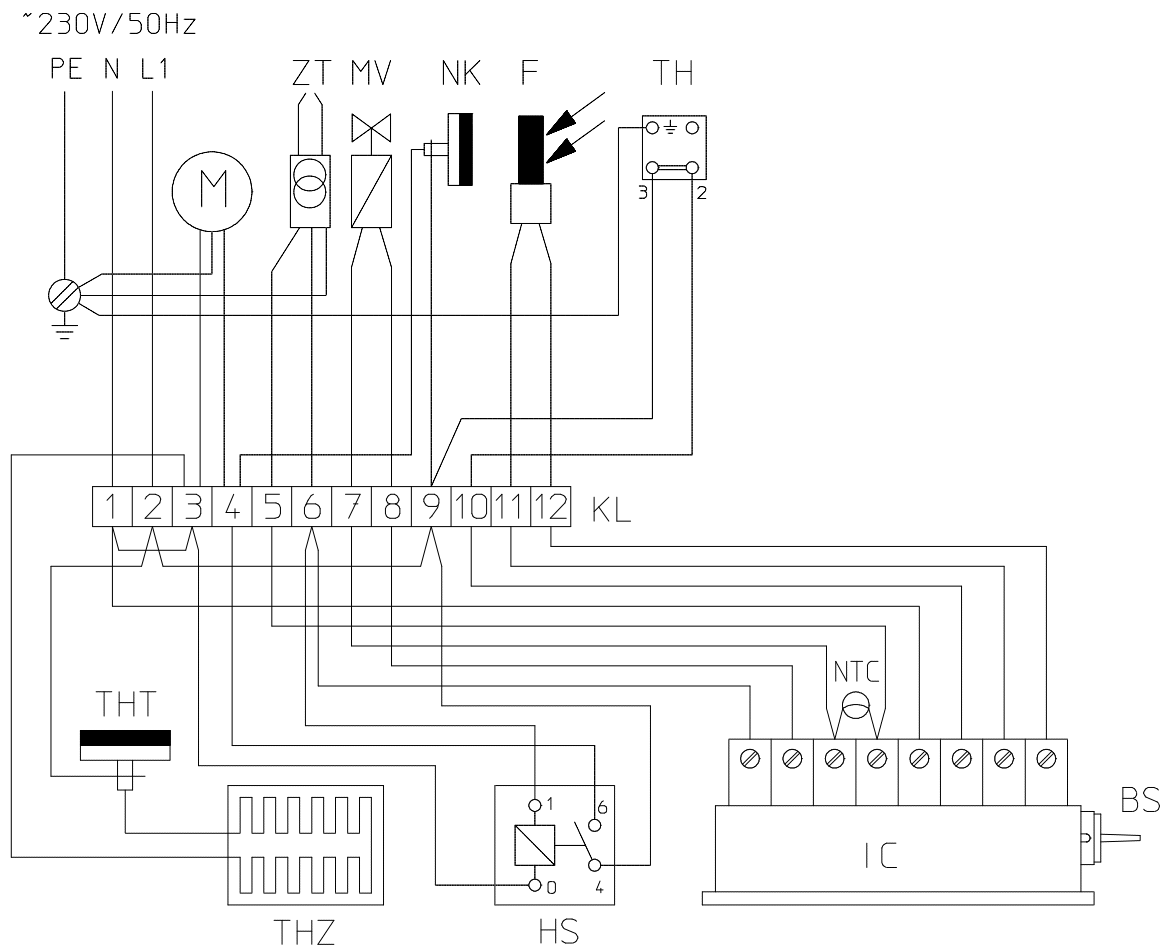

- | | |
|-----------------------|---------------------------------|
| BS = operating switch | NK = recool thermostat |
| F = photo cell | NTC = resistance |
| HS = auxiliary relay | TH = thermostat socket |
| IC = control-IC | THT = thermostat (tank heating) |
| KL = terminal strip | THZ = tank heating |
| M = motor | ZT = ignition transformer |
| MV = solenoid valve | |

Service and Guarantee

Any claims under guarantee regarding materials can be accepted only when the orderer or his customer has filled in completely the "guarantee certificate" which is enclosed with every REMKO-heater and has returned it to REMKO GmbH & Co. KG in due time after the unit's sale and commissioning.

An operation/use other than that indicated in these instructions is prohibited!

In the case of non-observation we will not be held responsible and our guarantee will become void.

The units are factory tested on faultless function. If any failures occurs though which cannot be eliminated by the operating person, please contact your dealer or contact person.

Troubleshooting

Trouble:	Cause:
– unit does not start.	2 – 3 – 4 – 5 – 6 – 7
– motor is running but burner will not be ignited.	1 – 8 – 9 – 10 – 11 – 12 – 13 – 14 – 15 – 16 – 18 – 19 – 21 – 22
– unit stops during operation. fault LED of the control IC (unit backside) lights up.	5 – 11 – 12 – 14 – 15 – 16 – 18 – 19 – 20 – 21 – 22
– smoke forming at the blow-out cone.	10 – 12 – 14 – 16 – 18 – 19 – 20
– flame leakage at the blow-out side (front).	10 – 12 – 14 – 16 – 18 – 19 – 20
– fuel consumption is too high.	10 – 14
– unit can't be switched off.	5 – 17



The mains plug has been taken out of the mains socket before carrying out any work regarding the unit. Setting and maintenance is to be carried out only by authorised experts!



Cause:	Remedy
1. Air (bubbles) in the fuel system during starting procedure.	– Press operating switch, repeat if necessary (max. 3 x).
2. No electrical connection.	– Check mains, mains plug and current.
3. No (bridge circuit-/thermostat-) plug in the thermostat socket.	– Connect bridge circuit plug resp. thermostat plug with the thermostat socket.
4. Thermostat setting is too low.	– Set thermostat higher than the room temperature.
5. Faults in the control IC.	– Replace control IC.
6. Motor is overcharged. (Fan blows irregularly or is blocked).	– Let motor cool down. – Check slight run of fuel pump. – Check motor on electrical and mechanical function.
7. Fuel pump is blocked.	– Check resp. replace fuel pump.
8. Fuel tank is empty.	– Fill fuel tank with clean fuel.
9. Fuel filter is blocked (dirty).	– Clean fuel filter resp. replace if necessary.
10. Nozzle is blocked resp. wrong dimension (type/size).	– Replace nozzle (take care of correct type and size!).
11. Wrong setting of ignition electrodes or damaged insulation.	– Adjust correctly resp. replace it.
12. Air flow plate of the burner head is misadjusted resp. dirty.	– Adjust correctly by means of CO ₂ –indicator and soot pump. (CO ₂ : 10 – 12% and soot figure by Bacharach: 0 – 1).
13. Solenoid valve does not open.	– Check solenoid valve (a „click“ should be heard during switching on/off) otherwise replace it.
14. Misadjusted pump pressure.	– Set pump pressure by means of a pressure-gauge.
15. Pump clutch is defect.	– Replace pump clutch.
16. Leakage in suction pipe or in fuel filter.	– Check suction pipe and fuel filter, replace if necessary.
17. Solenoid valve does not close.	– Pull off the fuel pipe from the main filter - the flame dies.
18. Air protecting grille is dirty.	– Clean air protecting grille.
19. Air (bubbles) in the fuel system.	– Restart the unit in order to discharge the air through the nozzle; this procedure can be repeated up to max. 3 times.
20. No adequate ventilation.	– Open doors or windows
21. Photo cell is dirty/defective.	– Clean resp. replace photo cell.
22. Fuel with paraffin accumulation. (Already occur starting from 5 °C see notes in chapter "Starting"). The tank heating is damaged (very rarely).	– Clean the entire fuel system. – Replace the damage tank heating.

Maintenance Log

Model :

Model No. :

	1	2	3	4	5	6	7	8	9	10	11	12	13	14	15	16	17	18	19	20
Clean unit -surface-																				
Clean unit -interior-																				
Clean fan																				
Clean combustion chamber																				
Clean burner head																				
Adjust ignition electrode																				
Replace nozzle																				
Clean / replace fuel filter																				
Adjust / measuring burner																				
Check safety facility																				
Check protection guards																				
Check unit for damage																				
Check fastening screws																				
Electric safety-inspections																				
Test run																				

Remarks:

.....

1. Date:..... Signature	2. Date:..... Signature	3. Date:..... Signature	4. Date:..... Signature	5. Date:..... Signature
6. Date:..... Signature	7. Date:..... Signature	8. Date:..... Signature	9. Date:..... Signature	10. Date:..... Signature
11. Date:..... Signature	12. Date:..... Signature	13. Date:..... Signature	14. Date:..... Signature	15. Date:..... Signature
16. Date:..... Signature	17. Date:..... Signature	18. Date:..... Signature	19. Date:..... Signature	20. Date:..... Signature

Setting and maintenance work is to be carried out only by authorised specialists!

REMKO GmbH & Co. KG
Klima- und Wärmetechnik

D-32791 Lage • Im Seelenkamp 12
D-32777 Lage • PO Box 1827
Phone +49 (5232) 606 - 0
Fax +49 (5232) 606260