

Assembly instructions

**REMKO design hoods
for REMKO heat pumps WKF 70/120/180**

WDH 70, WDH 120, WDH 180





Read these operating instructions carefully before commissioning / using this device!

These instructions are an integral part of the system and must always be kept near or on the device.

Subject to modifications; No liability accepted for errors or misprints!

Translation of the original assembly instructions

Table of contents

1	Safety and usage instructions	4
1.1	General safety notes	4
1.2	Identification of notes	4
1.3	Personnel qualifications	4
1.4	Dangers of failure to observe the safety notes	4
1.5	Safety-conscious working	5
1.6	Safety instructions for the operator	5
1.7	Safety notes for installation and inspection tasks	5
1.8	Unauthorised modification and changes	5
1.9	Intended use	5
1.10	Guarantee	6
1.11	Transportation and packaging	6
1.12	Environmental protection and recycling	6
2	Technical data	7
2.1	Product data	7
3	Layout and installation of the design hood on the outdoor unit of the heat pump	8
4	Exploded view of product and spare parts list	10
5	Index	11

REMKO design hoods

1 Safety and usage instructions

1.1 General safety notes

Carefully read the operating manual before installing the accessory item. It provides useful tips and notes such as hazard warnings to prevent injury and material damage. Failure to follow the directions in this manual can endanger persons, the environment and the equipment itself or its components and will void any claims for liability.

Keep this operating manual close to the accessory item.

NOTICE!

The design hood must never be cleaned using a high pressure cleaner!

Do not use any sharp objects for cleaning!

1.2 Identification of notes

This section provides an overview of all important safety aspects for proper protection of people and safe and fault-free operation. The instructions and safety notes contained within this manual must be observed in order to prevent accidents, personal injury and material damage.

Notes attached directly to the accessory items must be observed in their entirety and be kept in a fully legible condition.

Safety notes in this manual are indicated by symbols. Safety notes are introduced with signal words which help to highlight the magnitude of the danger in question.

DANGER!

Contact with live parts poses an immediate danger of death due to electric shock. Damage to the insulation or individual components may pose a danger of death.

DANGER!

This combination of symbol and signal word warns of a situation in which there is immediate danger, which if not avoided may be fatal or cause serious injury.

WARNING!

This combination of symbol and signal word warns of a potentially hazardous situation, which if not avoided may be fatal or cause serious injury.

CAUTION!

This combination of symbol and signal word warns of a potentially hazardous situation, which if not avoided may cause injuries or material and environmental damage.

NOTICE!

This combination of symbol and signal word warns of a potentially hazardous situation, which if not avoided may cause material and environmental damage.



This symbol highlights useful tips and recommendations as well as information for efficient and fault-free operation.

1.3 Personnel qualifications

Personnel responsible for commissioning, operation, maintenance, inspection and installation must be able to demonstrate that they hold a qualification which proves their ability to undertake the work.

1.4 Dangers of failure to observe the safety notes

Failure to observe the safety notes may pose a risk to people, the environment and the units. Failure to observe the safety notes may void any claims for damages.

In particular, failure to observe the safety notes may pose the following risks:

- The failure of important unit functions.
- The failure of prescribed methods of maintenance and repair.
- Danger to people on account of electrical and mechanical effects.

1.5 Safety-conscious working

The safety notes contained in this manual, the existing national regulations concerning accident prevention as well as any internal company working, operating and safety regulations must be observed.

1.6 Safety instructions for the operator

The operational safety of the units and components is only assured providing they are used as intended and in a fully assembled state.

- The units and components may only be set up, installed and maintained by qualified personnel.
- The existing regulations concerning accident prevention must be adhered to.
- Do not operate units or components with obvious defects or signs of damage.
- Contact with equipment parts or components can lead to injuries.
- Ensure that electrical energy does not pose a risk.
- Regulations of the VDE and the local energy supply company must be adhered to.

! NOTICE!

The design hood must never be cleaned using a high pressure cleaner!

Do not use any sharp objects for cleaning!

1.7 Safety notes for installation and inspection tasks

- The operator must ensure that all inspection and installation work is carried out by authorised and qualified personnel who have thoroughly read the operating manual.
- Work on the design hood must only ever be carried out when the system is stationary.
- Appropriate hazard prevention measures must be taken to prevent risks to people when performing installation, repair, maintenance or cleaning work on the units.
- The setup, connection and operation of the units and its components must be undertaken in accordance with the usage and operating conditions stipulated in this manual and comply with all applicable regional regulations.
- Regional regulations and laws as well as the Water Ecology Act (WHG) must be observed.
- The units and components must be kept at an adequate distance from flammable, explosive, combustible, abrasive and dirty areas or atmospheres.

CAUTION!

Ensure that the outdoor unit is put out of operation and secured to prevent a restart during the installation, maintenance or repair of the design hood, in order to prevent injuries caused by the fan starting up!

1.8 Unauthorised modification and changes

The operational safety of the noise protection hood that was delivered is guaranteed only when used as intended.

Modifications or changes to units and components are not permitted and may cause malfunctions. Original replacement parts and accessories authorised by the manufacturer ensure safety. The use of other parts may invalidate liability for resulting consequences.

1.9 Intended use

The design hood is designed for the visual enhancement and weather protection of outdoor units of the heat pumps.

Any different or additional use is a non-intended use. The manufacturer/supplier assumes no liability for damages arising from non-intended use. The user bears the sole risk in such cases. Intended use also includes working in accordance with the operating and installation instructions and complying with the maintenance requirements.

REMKO design hoods

The threshold values specified in the technical data must not be exceeded.

1.10 Guarantee

As a prerequisite for any guarantee claims to be considered, it is essential that the ordering party or its representative complete and return the "certificate of warranty" to REMKO GmbH & Co. KG at the time when the units are purchased and commissioned. The warranty conditions are listed in the "General terms and conditions". Furthermore, only the parties to a contract can conclude special agreements beyond these conditions. In this case, contact your contractual partner in the first instance.

1.11 Transportation and packaging

The items are shipped in sturdy transport packaging. Immediately check the components upon delivery and make a note of any damage or missing parts on the delivery note. Inform the forwarding agent and contractual partner. Claims under guarantee made at a later date will not be accepted.

WARNING!

Plastic films and bags etc. are dangerous toys for children!

Why:

- Leave packaging material are not around.
- Packaging material may not be accessible to children!

NOTICE!

Sharp objects will damage the design hood's surface.

Remove the packaging carefully!

1.12 Environmental protection and recycling

Disposal of packaging

All products are packed for transport in environmentally friendly materials. Make a valuable contribution to reducing waste and sustaining raw materials. Only dispose of packaging at approved collection points.



Disposing of the units and their components

For the manufacture of the units and components, only recyclable materials have been used. Help protect the environment by ensuring that the units or components (for example batteries) are not disposed of in household waste, but only in accordance with local regulations and in an environmentally safe manner, e.g. using authorised disposal and recycling specialists or council collection points.



2 Technical data

2.1 Product data

Series		WDH 70	WDH 120	WDH 180
Heat pump type		WKF 70	WKF 120	WKF 180
Aluminium version				
Colour of finned grille		similar to RAL 9006		
EDP no.		260960	260970	260980
Graphite version				
Colour of finned grille		similar to RAL 7021		
EDP no.		260961	260971	260981
Camura version				
Colour of finned grille		Wood look		
EDP no.		260962	260972	260982
Hood dimensions				
Height	mm	655	1000	1425
Width	mm	1110		
Depth	mm	435		
Weight	kg	25	35	48

We reserve the right to make technical changes for the purpose of technical advancement.

REMKO design hoods

3 Layout and installation of the design hood on the outdoor unit of the heat pump

CAUTION!

Ensure that the outdoor unit is put out of operation and secured to prevent a restart during the installation, maintenance or repair of the design hood, in order to prevent injuries caused by the fan starting up!

In order to assemble the design hood, proceed as follows:

1. ➤ Install the outdoor unit with the relevant floor consoles and the condensate catch pan (Fig. 1) as described in the relevant installation manual for the heat pump. We recommend using the REMKO BK 600/1000 plus floor consoles for installation. (Art. no. 260023/260024).



Fig. 1

2. ➤ The design hood is supplied fully assembled, so that you only require sufficient space for positioning.
3. ➤ Before placing the design hood over the heat pump, it is necessary to insert the fastening strap supplied into the two corresponding eyelets in the lower part of the design cover (Fig. 2-A). Pull the fastening strap through both eyelets until both ends are about the same length on each side and leave them lying loosely on the floor (Fig. 2-B).

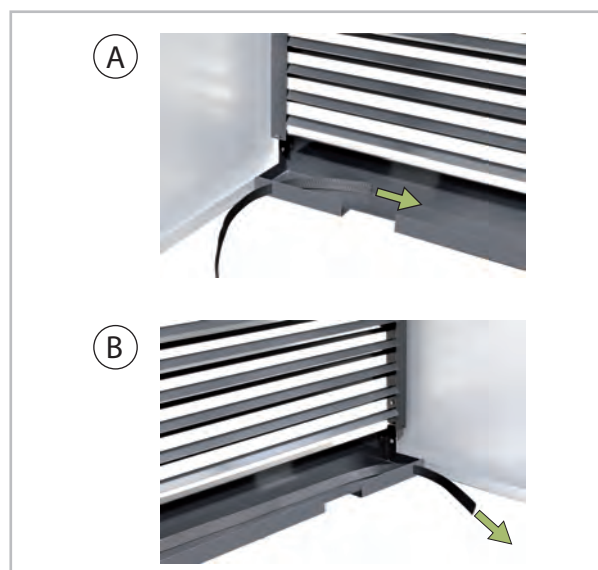

Fig. 2

4. ➤ Proceed as follows for assembly:

Carefully lift the design hood evenly on both sides and as straight as possible over the outdoor unit (Fig. 3).

NOTE: We recommend performing this step together with a second person (Fig. 4).

The finned grille of the hood faces the front (fan) of the outdoor unit.

Please grasp the design hood by the fins on the sides, at the outside edges. Otherwise there is a risk of the fins being bent (Fig. 5).

Make sure that the electrical cable and the refrigerant piping are not damaged.

The recesses on the L-profile of the design hood must fit correctly around the feet of the heat pump.

The fins of the heat exchanger (on the heat pump rear) must then be exposed and visible.



Fig. 3



Fig. 4



Fig. 5

5. → Now grasp both ends of the fastening strap and guide them from both sides along the lower rear side of the outdoor unit.

Close the fastening strap in such a way that it rests against the rear feet. The fastening strap should be tightened as firmly as possible, to secure the design hood. When doing so, take care to avoid damaging the paint finish on the outdoor unit and the insulation on the refrigerant piping.



Fig. 6

Dismantling for maintenance of the outdoor unit

For dismantling, please proceed in reverse order to the installation instructions from step 5 up to and including step 4.

REMKO design hoods

4 Exploded view of product and spare parts list

Exploded view of product WDH 70-180

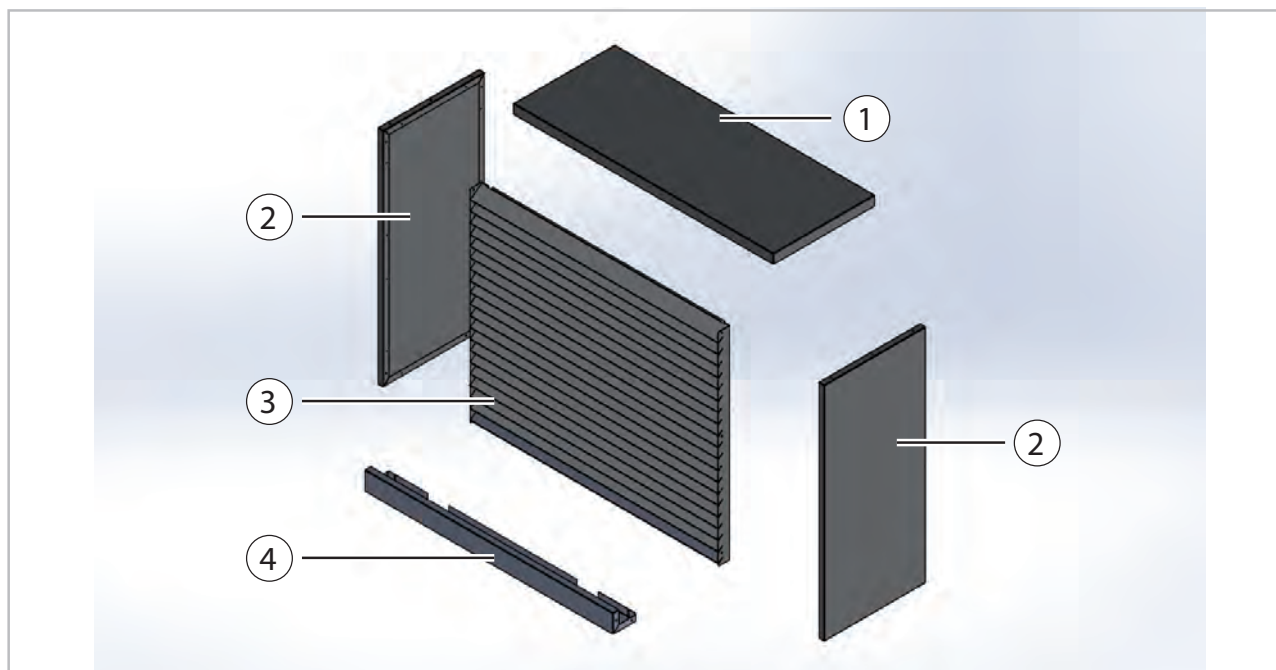

Spare parts WDH 70-180

No.	Spare parts	Version		
		Aluminium	Graphite	Camura
		EDP no.	EDP no.	EDP no.
1	Cover - WDH 70-180	1122801	1122801	1122801
2	Side section, left/right			
	WDH 70 → WKF 70	1122800	1122800	1122800
	WDH 120 → WKF 120	1122806	1122806	1122806
	WDH 180 → WKF 180	1122811	1122811	1122811
3	Finned grille			
	WDH 70 → WKF 70	1122803	1122804	1122805
	WDH 70 → WKF 120	1122808	1122809	1122810
	WDH 180 → WKF 180	1122812	1122813	1122814
4	Front panel, lower			
	WDH 70 → WKF 70	1122802	1122802	1122802
	WDH 70 → WKF 120 / WDH 180 → WKF 180	1122807	1122807	1122807
	Spare parts not illustrated			
	Fastening strap	1000967	1000967	1000967

5 Index

A

Assembly 8

D

Dismantling 9

E

Environmental protection 6

Exploded view of product 10

G

Guarantee 6

I

Intended use 5

P

Packaging, disposal 6

R

Recycling 6

S

Safety

Dangers of failure to observe the safety

notes 4

General 4

Identification of notes 4

Note for inspection work 5

Note for installation work 5

Notes for the operator 5

Personnel qualifications 4

Safety-conscious working 5

Unauthorised modification 5

Unauthorised replacement part manufacture . 5

Spare parts 10

T

Technical data 7

U

Unit disposal 6

REMKO QUALITY WITH SYSTEMS

Air-Conditioning | Heating | New Energies

REMKO GmbH & Co. KG
Klima- und Wärmetechnik

Im Seelenkamp 12
32791 Lage

Telephone +49 (0) 5232 606-0
Telefax +49 (0) 5232 606-260

E-mail info@remko.de
URL www.remko.de

Hotline within Germany
+49 (0) 5232 606-0

Hotline International
+49 (0) 5232 606-130

